



CITY OF CLAYTON

Community Facilities District No. 1990-1R 2007 Special Tax Revenue Refunding Bonds (Middle School)

Annual Report

June 2017

OFFICE LOCATIONS:

Temecula – Corporate Headquarters
32605 Temecula Parkway, Suite 100
Temecula, CA 92592

San Francisco – Regional Office
870 Market Street, Suite 1223
San Francisco, CA 94102

California Satellite Offices
Atascadero, Davis
Huntington Beach,
Joshua Tree, Riverside
Sacramento, San Jose

Prepared by:



www.nbsgov.com

CITY OF CLAYTON
6000 Heritage Trail
Clayton, California 94517
Phone – 925.673.7300
Fax – 925.672.4917

City Staff

Gary Napper, City Manager
Kevin Mizuno, Finance Director

Bond Counsel

James L. Copeland
Sidley Austin
San Francisco, California
415.772.1200

Paying Agent

Myrna Presto-Choroski
U.S. Bank Trust, N.A.
San Francisco, California
415.677.3599

Underwriter

Piper Jaffray Inc.
San Francisco, California
415.984.5170

Special Tax Administrator

NBS
Tim Seufert, Client Services Director
Greg Davidson, Director
Kristin Harvey, Senior Consultant

TABLE OF CONTENTS

1. EXECUTIVE SUMMARY/SPECIAL ISSUES	1-1
1.1. General Information Summary	1-1
2. FUND ANALYSIS.....	2-1
2.1. Fund Balances.....	2-1
2.2. Acquisition and Construction Fund Analysis.....	2-1
2.3. Reserve Fund.....	2-2
2.4. Revenue Fund.....	2-2
2.5. Special Tax Fund	2-3
2.6. Rebate Fund	2-3
3. 2017/18 LEVY	3-1
3.1. Special Tax Spread.....	3-1
3.2. Annual Levy Components.....	3-1
3.3. Levy Summary	3-2
4. DELINQUENCY MANAGEMENT	4-1
4.1. Delinquency Summary	4-1
4.2. Foreclosure Covenant	4-1
4.4. Teeter Plan Participation & County Revenue Apportionment Schedule	4-2
4.5. Delinquency Summary Report	4-2
5. DEBT SERVICE SCHEDULE	5-1
6. RATE AND METHOD OF APPORTIONMENT	6-1
6.1. Special Tax Formula.....	6-1
6.2. Residence Special Tax.....	6-1

6.3. Residential Land Special Tax.....	6-1
7. BACKGROUND INFORMATION	7-1
7.1. Project Description	7-1
7.2. Resolution.....	7-1
7.3. Boundary Map.....	7-2
8. DELINQUENCY DETAIL.....	8-1
9. 2017/18 SPECIAL TAX ROLL	9-1

1. EXECUTIVE SUMMARY/SPECIAL ISSUES

1.1. General Information Summary

Maturity Date	2017/18 Levy	Parcel Count	Delinquency Rate(1)	Assessed Value(2)	Outstanding Principal(3)	Value to Outstanding Principal Ratio(4)
9/2/2022	\$397,795.70	1,358	0.96%	\$752,032,727.00	\$2,058,000.00	365.42:1

(1) Delinquency Rate for Fiscal Year 2016/17.

(2) The Assessed Value for all active parcels within the District as of January 1, 2017.

(3) Outstanding principal after the Fiscal Year 2016/17 debt service has been paid.

(4) Assessed Value as of January 1, 2017 of all active parcels, divided by the outstanding principal for the District after the Fiscal Year 2016/17 debt service has been paid.

The Community Facilities District No. 1990-1 Special Tax Bonds were refunded in 1997 by the Clayton Financing Authority 1997 Special Tax Revenue Refunding Bonds. In 2007, the Clayton Financing Authority refunded the 1997 Special Tax Revenue Bonds with the issuance of the 2007 Special Tax Revenue Refunding Bonds.

All taxable parcels within the District are levied a Special Tax of 63.66% of their respective Maximum Special Tax Rate for Fiscal Year 2017/18. A credit in the amount of \$136,502.20 was applied to the Fiscal Year 2017/18 Special Tax Levy. This credit includes \$67,947.00 based on annual Debt Service cash flow between the 2007 Special Tax Revenue Refunding Bonds and CFD 1990-1R Local Obligation bonds and \$68,555.20 based on available district funds.

The delinquency rate for the District was 0.96% for Fiscal Year 2016/17. With the City's authorization, NBS sent reminder and demand letters to delinquent property owners. NBS recommends the City continue to take delinquency management action by sending letters to delinquent property owners in order to maintain a low delinquency rate.

2. FUND ANALYSIS

2.1. Fund Balances

Fund balances as of June 30, 2017 for the District are shown in the following table:

Fund Name	Fund Balance
Acquisition & Construction ⁽¹⁾	\$0.00
Reserve Fund ⁽¹⁾	251,990.00
Revenue Funds ⁽¹⁾	0.00
Special Tax Fund ^{(1) (2)}	2,552,978.00
Rebate Fund	0.00
City Held Funds ⁽³⁾	352,717.00
Total	\$3,157,685.00

(1) Funds are held by the Clayton Financing Authority.

(2) The Special Tax Fund includes the Redemption Account, Redemption Account Refunding, Bond Reserve Account and Expense Account.

(3) Projected June 30, 2017 fund balance.

2.2. Acquisition and Construction Fund Analysis

The Acquisition and Construction Fund is created upon formation of the District. All bond proceeds not associated with the financing and administrative costs of the bond issuance are deposited in this Fund to pay for the improvements to be constructed and/or acquired. Once the project has been completed, any remaining balance in the Fund must be treated in accordance with the Bond Indenture.

Some of the requirements of the Act are handled at the formation (bond issuance) of the District and others are handled through annual reports. This section of the report intends to comply with Section 53411 of the California Government Code that states:

“The chief fiscal officer of the issuing local agency shall file a report with its governing body no later than January 1, 2002, and at least once a year thereafter. The annual report shall contain all of the following:

- (a) The amount of funds collected and expended.
- (b) The status of any project required or authorized to be funded as identified in subdivision (a) of Section 53410.”

All money in the Acquisition and Construction Fund is used for payment of the acquisition and construction of the authorized facilities of the District. The improvements have been completed and there are no remaining amounts within the Acquisition and Construction Fund.

2.3. Reserve Fund

Moneys in the Reserve Fund shall be used by the Fiscal Agent solely for the purpose of paying the interest on or principal of or redemption premiums, if any on the bonds in the event there is insufficient money in the Redemption Account available for these purposes. In such case, the Reserve Fund is to be replenished up to the Reserve Requirement as soon as funds become available. Excess funds in the Reserve Fund shall be transferred to the Redemption Account for use in payment of Bond debt service.

The Reserve Fund was established at the time the original bonds were issued. As a result of the refunding, a Reserve Fund is held by the Clayton Financing Authority for the new issue of bonds.

The initial deposit to the Reserve Fund was \$251,982.51 for the 2007 Special Tax Revenue Refunding Bonds. The remaining funds, in the amount of \$206,168.51, are secured by a Qualified Reserve Fund Credit instrument in a form of a surety bond issued by Ambac Assurance Corporation at the time of issuance of the Bonds.

The Reserve Requirement is defined as an amount equal to the least of: (i) 10% of the initial principal amount of the Bonds, (ii) maximum annual debt service on the outstanding Bonds, or (iii) 125% of the average annual debt service on the outstanding Bonds, provided that in no event shall the Reserve Requirement exceed \$458,150.02.

2.4. Revenue Fund

The Revenue Fund consists of the Interest Account and Principal Account. In accordance with the Bond Indenture, the trustee shall deposit all revenues received after the closing date (defined as June 7, 2007) to the Revenue Fund and shall apply amounts in the Revenue Fund as follows.

On each interest payment date and date for redemption of the Bonds, the trustee shall transfer from the Revenue Fund, and deposit into the following respective accounts for the Bonds, the following amounts in the following order of priority, the requirements of each such account (including the making up of delinquencies in any such account resulting from lack of revenue sufficient to make any earlier required deposit) at the time of deposit to be satisfied before any transfer is made to any account subsequent in priority:

- (a) Interest Account
- (b) Principal Account
- (c) Reserve Fund

On each interest payment date after making the transfers required above, upon receipt of a request of the Authority to do so, the trustee shall transfer from the Revenue Fund to the Rebate Fund for deposit in the accounts therein the amounts specified in such request.

On September 2 of each year, after making the deposits required above, the trustee shall transfer all amounts remaining on deposit in the Revenue Fund to the Surplus Fund.

2.5. Special Tax Fund

All money in the Special Tax Fund shall be set aside in the following respective accounts within the Special Tax Fund in the following order of priority, and all money in each of such accounts shall be applied, used and withdrawn only for the purposes authorized in the Fiscal Agent Agreement:

- (a) Redemption Account,
- (b) Reserve Account,
- (c) Expenses Account, and
- (d) Prepayment Account.

2.6. Rebate Fund

The City has covenanted to comply with all of the requirements of Section 148 of the Internal Revenue Code (the "Code") relating to the calculation and payment of any arbitrage rebate amount. Section 148 requires that the specific exceptions, any interest earnings in excess of the bond yield for each bond issue must be rebated to the IRS.

The following table shows the date of the most recent calculation, and the amount of liability (if any):

Most Recent Calculation As of Date	Liability
September 2, 2016	(\$31,368.51)

3. 2017/18 LEVY

3.1. Special Tax Spread

All taxable parcels within the District were levied a Special Tax of 63.66% of their respective Maximum Special Tax for Fiscal Year 2017/18. The following table provides the Special Tax Levy breakdown for the District for 2017/18.

Total Amount Levied	Maximum Special Tax	Percentage of Maximum
\$397,795.70	\$624,874.00	63.66%

3.2. Annual Levy Components

Pursuant to the California Government Code, administrative expenses are identified by consultation with City staff to ensure that the District is self-supporting and is not being subsidized by the City's General Fund.

NBS assists the City with identifying and recovering the following general costs:

- Agency administrative costs. This includes the value of City staff time spent on the administration of the District, calculated by using a fully-loaded salary rate that includes benefits and overhead costs. Any City expenses that have been incurred, such as copying and mailing expenses, are also recovered as part of this calculation.
- Trustee or Paying Agent costs. Includes the total of Trustee/Paying Agent charges to the City for the annual processing of payments to the bondholders, as well as registration and transfer functions that have been performed.
- County Auditor-Controller collection fees. Fees charged by the County Auditor-Controller to place the Special Tax installments on the tax roll each year are identified and recovered.
- Arbitrage Rebate calculation costs. Includes all fees and costs associated with the calculation of the District's arbitrage rebate amount in compliance with Internal Revenue Service Arbitrage Rebate Requirements.
- SEC-required disclosure costs. Administrative costs related to compliance with the Securities and Exchange Commission's requirements for continuing disclosure and dissemination of material events occurring within the District.
- Administration costs. Also fully recoverable are the costs incurred by NBS, as the administrator, in the year-round administration of the District, which includes the preparation of the annual levy, ongoing reporting to the City, and the tracking of activity within the District such as Special Tax prepayments, installment payments and parcel changes.
- Delinquency Management charges. The cost of any delinquency management actions taken on behalf of parcels with delinquencies, including the mailing of reminder, demand and/or foreclosure letters, and the work associated with the initiation of judicial foreclosure as required by the bond covenants.

- Manual adjustments. If special circumstances are discovered, credits and/or charges are made as necessary to the annual Special Tax installment amount for the specific parcels affected by the situation.
- NBS analyzes the fund balances each year. Interest earnings and/or surplus funds that exist may be applied to the annual levy as a credit to reduce each parcel's annual installment. These balances must also be closely monitored to prevent violations of IRS arbitrage regulations.

3.3. Levy Summary

The following table summarizes the components that make up the 2017/18 Levy for the District. Information from the 2016/17 Levy is also included for comparison purposes.

City of Clayton
Community Facilities District 1990-1R
Final Budget for Fiscal Year 2017/18

Category/Item	FY 2017/18	FY 2016/17	Increase / (Decrease)
Debt Service	\$495,831.74	\$498,072.00	(\$2,240.26)
Admin. Expenses	38,270.10	37,043.56	1,226.54
Miscellaneous	(136,306.14)	(133,316.98)	(2,989.16)
Grand Total:	\$397,795.70	\$401,798.58	(\$4,002.88)
Total Accounts:	1,358	1,358	0

4. DELINQUENCY MANAGEMENT

4.1. Delinquency Summary

The following table shows the Fiscal Year 2016/17 delinquency rate for the District:

2016/17 Levy	2016/17 Delinquencies	2016/17 Delinquency Rate	Delinquency Management Steps Taken
\$401,798.58	\$3,857.73	0.96%	Reminder and Demand Letters sent

NBS monitors the delinquency rate and reviews the delinquency situation after each payment date. With the City's authorization, NBS sent reminder and demand letters to delinquent property owners.

Refer to Section 7 of this report for the Delinquency Detail Report for the District.

4.2. Foreclosure Covenant

The City has covenanted that it will initiate judicial foreclosure against parcels with Special Tax delinquencies. In today's environment of higher delinquency rates and greater bondholder scrutiny of City activities, any non-compliance with foreclosure covenants may expose the City to bondholder lawsuits.

NBS assists the City by providing a comprehensive delinquency management program including discussion of the issuer's foreclosure covenant, providing delinquency information from the County's redemption tapes, and coordinating with the City on the necessary steps required to implement a delinquency management policy. Once a policy is established, City compliance is easier to document and complaints from affected parcel owners can be minimized by showing the City's even-handed, unbiased covenant enforcement.

The foreclosure covenant is defined as follows:

The City has covenanted that it will review the public records of the county relating to the collection of the Special Tax annually on or before June 1 in order to determine the delinquencies within the District. If the Special Tax delinquency rate is greater than 5%, the City shall commence judicial foreclosure proceedings within 30 days. In addition, the City has covenanted to commence judicial foreclosure proceedings against any property owner with a combined delinquency of \$25,000 or more.

4.4. Teeter Plan Participation & County Revenue Apportionment Schedule

The District participates in the Contra Costa County Teeter Plan. Details of the apportionment of funds from the County to the City are provided below.

County Revenue Apportionment Schedule

Date	Percentage Apportioned
12/15	55%
4/15	40%
6/25	5%

4.5. Delinquency Summary Report

The following pages summarize delinquencies for the 2016/17 and prior fiscal years.

City of Clayton

Delinquency Summary Report

As of: 06/07/2017

District	Due Date	Billed Amount	Paid Amount	Delinquent Amount	Delinquent Amount %	Billed Installments	Paid Installments	Delinquent Installments	Delinquent Installments %
CFD1990-1R									
08/01/1997 Billing:									
	12/10/1997	\$283,581.00	\$283,581.00	\$0.00	0.00%	1,256	1,256	0	0.00%
	04/10/1998	\$283,581.00	\$283,581.00	\$0.00	0.00%	1,256	1,256	0	0.00%
	Subtotal:	\$567,162.00	\$567,162.00	\$0.00	0.00%	2,512	2,512	0	0.00%
08/01/1998 Billing:									
	12/10/1998	\$299,009.88	\$299,009.88	\$0.00	0.00%	1,357	1,357	0	0.00%
	04/10/1999	\$299,009.88	\$299,009.88	\$0.00	0.00%	1,357	1,357	0	0.00%
	Subtotal:	\$598,019.76	\$598,019.76	\$0.00	0.00%	2,714	2,714	0	0.00%
08/01/1999 Billing:									
	12/10/1999	\$312,437.00	\$312,437.00	\$0.00	0.00%	1,358	1,358	0	0.00%
	04/10/2000	\$312,437.00	\$312,437.00	\$0.00	0.00%	1,358	1,358	0	0.00%
	Subtotal:	\$624,874.00	\$624,874.00	\$0.00	0.00%	2,716	2,716	0	0.00%
08/01/2000 Billing:									
	12/10/2000	\$269,276.64	\$269,276.64	\$0.00	0.00%	1,358	1,358	0	0.00%
	04/10/2001	\$269,276.64	\$269,276.64	\$0.00	0.00%	1,358	1,358	0	0.00%
	Subtotal:	\$538,553.28	\$538,553.28	\$0.00	0.00%	2,716	2,716	0	0.00%
08/01/2001 Billing:									
	12/10/2001	\$271,004.12	\$271,004.12	\$0.00	0.00%	1,358	1,358	0	0.00%
	04/10/2002	\$271,004.12	\$271,004.12	\$0.00	0.00%	1,358	1,358	0	0.00%
	Subtotal:	\$542,008.24	\$542,008.24	\$0.00	0.00%	2,716	2,716	0	0.00%
08/01/2002 Billing:									
	12/10/2002	\$270,571.30	\$270,571.30	\$0.00	0.00%	1,358	1,358	0	0.00%
	04/10/2003	\$270,571.30	\$270,571.30	\$0.00	0.00%	1,358	1,358	0	0.00%
	Subtotal:	\$541,142.60	\$541,142.60	\$0.00	0.00%	2,716	2,716	0	0.00%

City of Clayton

Delinquency Summary Report

As of: 06/07/2017

District	Due Date	Billed Amount	Paid Amount	Delinquent Amount	Delinquent Amount %	Billed Installments	Paid Installments	Delinquent Installments	Delinquent Installments %
CFD1990-1R									
08/01/2003 Billing:									
	12/10/2003	\$271,552.81	\$271,552.81	\$0.00	0.00%	1,358	1,358	0	0.00%
	04/10/2004	\$271,552.81	\$271,552.81	\$0.00	0.00%	1,358	1,358	0	0.00%
	Subtotal:	\$543,105.62	\$543,105.62	\$0.00	0.00%	2,716	2,716	0	0.00%
08/01/2004 Billing:									
	12/10/2004	\$269,663.04	\$269,663.04	\$0.00	0.00%	1,358	1,358	0	0.00%
	04/10/2005	\$269,663.04	\$269,663.04	\$0.00	0.00%	1,358	1,358	0	0.00%
	Subtotal:	\$539,326.08	\$539,326.08	\$0.00	0.00%	2,716	2,716	0	0.00%
08/01/2005 Billing:									
	12/10/2005	\$270,437.60	\$270,437.60	\$0.00	0.00%	1,358	1,358	0	0.00%
	04/10/2006	\$270,437.60	\$270,437.60	\$0.00	0.00%	1,358	1,358	0	0.00%
	Subtotal:	\$540,875.20	\$540,875.20	\$0.00	0.00%	2,716	2,716	0	0.00%
08/01/2006 Billing:									
	12/10/2006	\$270,519.66	\$270,519.66	\$0.00	0.00%	1,358	1,358	0	0.00%
	04/10/2007	\$270,519.66	\$270,519.66	\$0.00	0.00%	1,358	1,358	0	0.00%
	Subtotal:	\$541,039.32	\$541,039.32	\$0.00	0.00%	2,716	2,716	0	0.00%
08/01/2007 Billing:									
	12/10/2007	\$254,356.75	\$254,356.75	\$0.00	0.00%	1,358	1,358	0	0.00%
	04/10/2008	\$254,356.75	\$254,356.75	\$0.00	0.00%	1,358	1,358	0	0.00%
	Subtotal:	\$508,713.50	\$508,713.50	\$0.00	0.00%	2,716	2,716	0	0.00%
08/01/2008 Billing:									
	12/10/2008	\$272,919.45	\$272,919.45	\$0.00	0.00%	1,358	1,358	0	0.00%
	04/10/2009	\$272,919.45	\$272,919.45	\$0.00	0.00%	1,358	1,358	0	0.00%
	Subtotal:	\$545,838.90	\$545,838.90	\$0.00	0.00%	2,716	2,716	0	0.00%

City of Clayton

Delinquency Summary Report

As of: 06/07/2017

District	Due Date	Billed Amount	Paid Amount	Delinquent Amount	Delinquent Amount %	Billed Installments	Paid Installments	Delinquent Installments	Delinquent Installments %
CFD1990-1R									
08/01/2009 Billing:									
	12/10/2009	\$277,213.42	\$277,213.42	\$0.00	0.00%	1,358	1,358	0	0.00%
	04/10/2010	\$277,213.42	\$277,213.42	\$0.00	0.00%	1,358	1,358	0	0.00%
	Subtotal:	\$554,426.84	\$554,426.84	\$0.00	0.00%	2,716	2,716	0	0.00%
08/01/2010 Billing:									
	12/10/2010	\$274,092.57	\$274,092.57	\$0.00	0.00%	1,358	1,358	0	0.00%
	04/10/2011	\$274,092.57	\$274,092.57	\$0.00	0.00%	1,358	1,358	0	0.00%
	Subtotal:	\$548,185.14	\$548,185.14	\$0.00	0.00%	2,716	2,716	0	0.00%
08/01/2011 Billing:									
	12/10/2011	\$238,015.42	\$238,015.42	\$0.00	0.00%	1,358	1,358	0	0.00%
	04/10/2012	\$238,015.42	\$238,015.42	\$0.00	0.00%	1,358	1,358	0	0.00%
	Subtotal:	\$476,030.84	\$476,030.84	\$0.00	0.00%	2,716	2,716	0	0.00%
08/01/2012 Billing:									
	12/10/2012	\$228,393.86	\$228,284.94	\$108.92	0.05%	1,358	1,357	1	0.07%
	04/10/2013	\$228,393.86	\$228,284.94	\$108.92	0.05%	1,358	1,357	1	0.07%
	Subtotal:	\$456,787.72	\$456,569.88	\$217.84	0.05%	2,716	2,714	2	0.07%
08/01/2013 Billing:									
	12/10/2013	\$217,137.99	\$217,137.99	\$0.00	0.00%	1,358	1,358	0	0.00%
	04/10/2014	\$217,137.99	\$217,137.99	\$0.00	0.00%	1,358	1,358	0	0.00%
	Subtotal:	\$434,275.98	\$434,275.98	\$0.00	0.00%	2,716	2,716	0	0.00%
08/01/2014 Billing:									
	12/10/2014	\$204,903.64	\$204,903.64	\$0.00	0.00%	1,358	1,358	0	0.00%
	04/10/2015	\$204,903.64	\$204,903.64	\$0.00	0.00%	1,358	1,358	0	0.00%
	Subtotal:	\$409,807.28	\$409,807.28	\$0.00	0.00%	2,716	2,716	0	0.00%

City of Clayton
Delinquency Summary Report

As of: 06/07/2017

District	Due Date	Billed Amount	Paid Amount	Delinquent Amount	Delinquent Amount %	Billed Installments	Paid Installments	Delinquent Installments	Delinquent Installments %
CFD1990-1R									
08/01/2015 Billing:									
	12/10/2015	\$202,900.84	\$202,762.19	\$138.65	0.07%	1,358	1,357	1	0.07%
	04/10/2016	\$202,900.84	\$202,762.19	\$138.65	0.07%	1,358	1,357	1	0.07%
	Subtotal:	\$405,801.68	\$405,524.38	\$277.30	0.07%	2,716	2,714	2	0.07%
08/01/2016 Billing:									
	12/10/2016	\$200,899.29	\$200,375.88	\$523.41	0.26%	1,358	1,353	5	0.37%
	04/10/2017	\$200,899.29	\$197,564.97	\$3,334.32	1.66%	1,358	1,335	23	1.69%
	Subtotal:	\$401,798.58	\$397,940.85	\$3,857.73	0.96%	2,716	2,688	28	1.03%
CFD1990-1R	Total:	\$10,317,772.56	\$10,313,419.69	\$4,352.87	0.04%	54,114	54,082	32	0.06%
Agency Grand Total:		\$10,317,772.56	\$10,313,419.69	\$4,352.87	0.04%	54,114	54,082	32	0.06%

5. DEBT SERVICE SCHEDULE

The following pages show the scheduled debt service payments for the District, including the Revenue Bonds.

City of Clayton
Community Facilities District 1990-1R
Current Debt Service Schedule

Bonds Dated: 11/19/1997
Bonds Issued: \$6,400,000.00

Payment Date	CUSIP	Interest Rate	Balance	Principal	Interest	Payment Total	Annual Total	Call Premium	Status
03/02/1998		6.5030%	\$6,400,000.00	\$0.00	\$119,077.16	\$119,077.16	\$0.00	3.0000%	Paid
09/02/1998		6.5030	6,400,000.00	.00	208,096.00	208,096.00	327,173.16	3.0000	Paid
03/02/1999		6.5030	6,400,000.00	.00	208,096.00	208,096.00	.00	3.0000	Paid
09/02/1999		6.5030	6,400,000.00	199,000.00	208,096.00	407,096.00	615,192.00	3.0000	Paid
03/02/2000		6.5030	6,201,000.00	.00	201,625.52	201,625.52	.00	3.0000	Paid
09/02/2000		6.5030	6,201,000.00	217,000.00	201,625.52	418,625.52	620,251.04	3.0000	Paid
03/02/2001		6.5030	5,984,000.00	.00	194,569.76	194,569.76	.00	3.0000	Paid
09/02/2001		6.5030	5,984,000.00	130,000.00	194,569.76	324,569.76	519,139.52	3.0000	Paid
03/02/2002		6.5030	5,854,000.00	.00	190,342.81	190,342.81	.00	3.0000	Paid
09/02/2002		6.5030	5,854,000.00	141,000.00	190,342.81	331,342.81	521,685.62	3.0000	Paid
03/02/2003		6.5030	5,713,000.00	.00	185,758.20	185,758.20	.00	3.0000	Paid
09/02/2003		6.5030	5,713,000.00	148,000.00	185,758.20	333,758.20	519,516.40	3.0000	Paid
03/02/2004		6.5030	5,565,000.00	.00	180,945.98	180,945.98	.00	3.0000	Paid
09/02/2004		6.5030	5,565,000.00	159,000.00	180,945.98	339,945.98	520,891.96	3.0000	Paid
03/02/2005		6.5030	5,406,000.00	.00	175,776.09	175,776.09	.00	3.0000	Paid
09/02/2005		6.5030	5,406,000.00	165,000.00	175,776.09	340,776.09	516,552.18	3.0000	Paid
03/02/2006		6.5030	5,241,000.00	.00	170,411.12	170,411.12	.00	3.0000	Paid
09/02/2006		6.5030	5,241,000.00	176,000.00	170,411.12	346,411.12	516,822.24	3.0000	Paid
03/02/2007		6.5030	5,065,000.00	.00	164,688.48	164,688.48	.00	3.0000	Paid
09/02/2007		6.5030	5,065,000.00	187,000.00	164,688.48	351,688.48	516,376.96	3.0000	Paid
03/02/2008		6.5030	4,878,000.00	.00	158,608.17	158,608.17	.00	3.0000	Paid
09/02/2008		6.5030	4,878,000.00	203,000.00	158,608.17	361,608.17	520,216.34	2.0000	Paid
03/02/2009		6.5030	4,675,000.00	.00	152,007.63	152,007.63	.00	2.0000	Paid
09/02/2009		6.5030	4,675,000.00	214,000.00	152,007.63	366,007.63	518,015.26	1.0000	Paid
03/02/2010		6.5030	4,461,000.00	.00	145,049.42	145,049.42	.00	1.0000	Paid
09/02/2010		6.5030	4,461,000.00	230,000.00	145,049.42	375,049.42	520,098.84	0.0000	Paid
03/02/2011		6.5030	4,231,000.00	.00	137,570.97	137,570.97	.00	0.0000	Paid
09/02/2011		6.5030	4,231,000.00	241,000.00	137,570.97	378,570.97	.00	0.0000	Paid
09/02/2011		0.0000	3,990,000.00	190,000.00	.00	190,000.00	706,141.94	0.0000	Bond Call
03/02/2012		6.5030	3,800,000.00	.00	123,557.00	123,557.00	.00	0.0000	Paid
09/02/2012		6.5030	3,800,000.00	246,000.00	123,557.00	369,557.00	493,114.00	0.0000	Paid
03/02/2013		6.5030	3,554,000.00	.00	115,558.31	115,558.31	.00	0.0000	Paid
09/02/2013		6.5030	3,554,000.00	261,000.00	115,558.31	376,558.31	492,116.62	0.0000	Paid
03/02/2014		6.5030	3,293,000.00	.00	107,071.90	107,071.90	.00	0.0000	Paid
09/02/2014		6.5030	3,293,000.00	281,000.00	107,071.90	388,071.90	495,143.80	0.0000	Paid
03/02/2015		6.5030	3,012,000.00	.00	97,935.18	97,935.18	.00	0.0000	Paid
09/02/2015		6.5030	3,012,000.00	296,000.00	97,935.18	393,935.18	491,870.36	0.0000	Paid
03/02/2016		6.5030	2,716,000.00	.00	88,310.74	88,310.74	.00	0.0000	Paid
09/02/2016		6.5030	2,716,000.00	316,000.00	88,310.74	404,310.74	492,621.48	0.0000	Paid
03/02/2017		6.5030	2,400,000.00	.00	78,036.00	78,036.00	.00	0.0000	Paid

City of Clayton
Community Facilities District 1990-1R
Current Debt Service Schedule

Bonds Dated: 11/19/1997
Bonds Issued: \$6,400,000.00

Payment Date	CUSIP	Interest Rate	Balance	Principal	Interest	Payment Total	Annual Total	Call Premium	Status
09/02/2017		6.5030	2,400,000.00	342,000.00	78,036.00	420,036.00	498,072.00	0.0000	Unpaid
03/02/2018		6.5030	2,058,000.00	.00	66,915.87	66,915.87	.00	0.0000	Unpaid
09/02/2018		6.5030	2,058,000.00	362,000.00	66,915.87	428,915.87	495,831.74	0.0000	Unpaid
03/02/2019		6.5030	1,696,000.00	.00	55,145.44	55,145.44	.00	0.0000	Unpaid
09/02/2019		6.5030	1,696,000.00	383,000.00	55,145.44	438,145.44	493,290.88	0.0000	Unpaid
03/02/2020		6.5030	1,313,000.00	.00	42,692.20	42,692.20	.00	0.0000	Unpaid
09/02/2020		6.5030	1,313,000.00	409,000.00	42,692.20	451,692.20	494,384.40	0.0000	Unpaid
03/02/2021		6.5030	904,000.00	.00	29,393.56	29,393.56	.00	0.0000	Unpaid
09/02/2021		6.5030	904,000.00	434,000.00	29,393.56	463,393.56	492,787.12	0.0000	Unpaid
03/02/2022		6.5030	470,000.00	.00	15,282.05	15,282.05	.00	0.0000	Unpaid
09/02/2022		6.5030	470,000.00	470,000.00	15,282.05	485,282.05	500,564.10	0.0000	Unpaid
Grand Total:				\$6,400,000.00	\$6,497,869.96	\$12,897,869.96	\$12,897,869.96		

City of Clayton
CFA 2007 Special Tax Revenue Bonds
Current Debt Service Schedule

Bonds Dated: 06/07/2007
Bonds Issued: \$5,060,000.00

Payment Date	CUSIP	Interest Rate	Balance	Principal	Interest	Payment Total	Annual Total	Call Premium	Status
03/02/2008		3.5000%	\$5,060,000.00	\$0.00	\$141,064.65	\$141,064.65	\$0.00	0.0000%	Paid
09/02/2008	184065AU4	3.5000	5,060,000.00	295,000.00	95,817.50	390,817.50	531,882.15	0.0000	Paid
03/02/2009		3.5000	4,765,000.00	.00	90,655.00	90,655.00	.00	0.0000	Paid
09/02/2009	184065AV2	3.5000	4,765,000.00	265,000.00	90,655.00	355,655.00	446,310.00	0.0000	Paid
03/02/2010		3.5000	4,500,000.00	.00	86,017.50	86,017.50	.00	0.0000	Paid
09/02/2010	184065AW0	3.5000	4,500,000.00	275,000.00	86,017.50	361,017.50	447,035.00	0.0000	Paid
03/02/2011		3.5000	4,225,000.00	.00	81,205.00	81,205.00	.00	0.0000	Paid
09/02/2011	184065AX8	3.5000	4,225,000.00	285,000.00	81,205.00	366,205.00	.00	0.0000	Paid
09/02/2011		0.0000	3,940,000.00	190,000.00	.00	190,000.00	637,410.00	0.0000	Bond Call
03/02/2012		3.5000	3,750,000.00	.00	72,541.88	72,541.88	.00	0.0000	Paid
09/02/2012	184065AY6	3.5000	3,750,000.00	280,000.00	72,541.88	352,541.88	425,083.76	0.0000	Paid
03/02/2013		3.6000	3,470,000.00	.00	67,641.88	67,641.88	.00	0.0000	Paid
09/02/2013	184065AZ3	3.6000	3,470,000.00	285,000.00	67,641.88	352,641.88	420,283.76	0.0000	Paid
03/02/2014		3.6250	3,185,000.00	.00	62,511.88	62,511.88	.00	0.0000	Paid
09/02/2014	184065BA7	3.6250	3,185,000.00	305,000.00	62,511.88	367,511.88	430,023.76	0.0000	Paid
03/02/2015		3.7000	2,880,000.00	.00	56,983.75	56,983.75	.00	0.0000	Paid
09/02/2015	184065BB5	3.7000	2,880,000.00	315,000.00	56,983.75	371,983.75	428,967.50	0.0000	Paid
03/02/2016		3.7500	2,565,000.00	.00	51,156.25	51,156.25	.00	0.0000	Paid
09/02/2016	184065BC3	3.7500	2,565,000.00	325,000.00	51,156.25	376,156.25	427,312.50	0.0000	Paid
03/02/2017		4.0000	2,240,000.00	.00	45,062.50	45,062.50	.00	0.0000	Paid
09/02/2017	184065BF6	4.0000	2,240,000.00	340,000.00	45,062.50	385,062.50	430,125.00	0.0000	Unpaid
03/02/2018		4.0000	1,900,000.00	.00	38,262.50	38,262.50	.00	0.0000	Unpaid
09/02/2018	184065BF6	4.0000	1,900,000.00	350,000.00	38,262.50	388,262.50	426,525.00	0.0000	Unpaid
03/02/2019		4.0000	1,550,000.00	.00	31,262.50	31,262.50	.00	0.0000	Unpaid
09/02/2019	184065BF6	4.0000	1,550,000.00	360,000.00	31,262.50	391,262.50	422,525.00	0.0000	Unpaid
03/02/2020		4.0000	1,190,000.00	.00	24,062.50	24,062.50	.00	0.0000	Unpaid
09/02/2020	184065BG4	4.0000	1,190,000.00	375,000.00	24,062.50	399,062.50	423,125.00	0.0000	Unpaid
03/02/2021		4.0000	815,000.00	.00	16,562.50	16,562.50	.00	0.0000	Unpaid
09/02/2021	184065BH2	4.0000	815,000.00	395,000.00	16,562.50	411,562.50	428,125.00	0.0000	Unpaid
03/02/2022		4.1250	420,000.00	.00	8,662.50	8,662.50	.00	0.0000	Unpaid
09/02/2022	184065BJ8	4.1250	420,000.00	420,000.00	8,662.50	428,662.50	437,325.00	0.0000	Unpaid
Grand Total:			\$5,060,000.00		\$1,702,058.43	\$6,762,058.43	\$6,762,058.43		

6. RATE AND METHOD OF APPORTIONMENT

6.1. Special Tax Formula

A Special Tax shall be levied on and collected from each parcel in the District in each fiscal year commencing on July 1, 1991, in an amount determined by the City Council of the City of Clayton through the application of the appropriate Special Tax for Residences and Residential Land.

The Special Tax shall be levied upon those lots and parcels listed in Table 1 of the Rate and Method of Apportionment within Subdivision 6990 (filed of record on December 20, 1988, in Book 328 of Maps, at Page 21, in the Official Records of the Contra Costa County Recorder) included within the boundaries of the District.

The Special Tax shall be levied on Residences and Residential Land.

Residence means a residential dwelling, and the subdivided lot upon which it is constructed, for which a certificate of occupancy has been issued by the City.

Residential Land means those lots and parcels listed in Table 1 excepting (1) Residences and (2) any lands not zoned or designated by the City for the construction of a Residence.

Wherever it is stated that the City shall designate the number of Residences or the land on which Residences are to be constructed, such designation shall be made at the time a subdivision map is filed of record.

6.2. Residence Special Tax

The Special Tax will be levied against a Residence following the issuance of a certificate of occupancy. For each fiscal year (July 1 - June 30), the Special Tax on a Residence will be levied against each Residence for which a certificate of occupancy has been issued by July 15 of that year.

The Special Tax for a Residence on a parcel showing one residence under Estimated Number of Residences on Table 1 shall be the amount shown for that parcel under Maximum Special Tax on Table 1.

The Special Tax for Residences on parcels showing a number greater than one under Estimated Number of Residences on Table 1 of the Rate and Method of Apportionment shall be determined as follows: When a subdivision map for such parcel is filed of record, the Special Tax for Residences on such parcel shall be apportioned equally to each new lot and parcel created by the subdivision map based on the number of Residences to be constructed thereon as designated by the City; no Special Tax shall be apportioned to any lands not zoned or designated for the construction of a Residence. Upon any further re-subdivision of a parcel created by such subdivision map, a further apportionment shall be made in a manner consistent with the preceding apportionment rules.

6.3. Residential Land Special Tax

Beginning July 1, 1991, and ending when there is no Residential Land in the District, a Residential Land Special Tax may be annually levied on the Residential Land. The total Residential Land Special Tax so levied shall be one hundred percent (100%) of the annual debt service, on the bonds to be issued by the District,

for the following bond year (increased to one hundred five percent (105%) commencing July 1, 1997), less the total of the following amounts:

- The total Residence Special Taxes to be levied for that fiscal year.
- Interest earnings available from unspent bond proceeds during the pre-development and construction period of the school, to the extent such earnings may be legally used to pay interest on the bonds for the following bond year pursuant to the Mello-Roos Community Facilities District Act of 1982.
- Any other funds which the City determines are available to the District for payment of the debt service for the following bond year other than those funds which are designated for other purposes.

The total Residential Land Special Tax resulting from the above calculation, but not more than such total tax, shall be apportioned to the Residential Land as follows:

- a. The Maximum Residential Land Special Tax for each subdivided lot zoned or designated by the City for the construction of a Residence shall be equal to the Maximum Residence Special Tax which would be levied on the lot if it were a Residence.
- b. The balance of the total Residential Land Special Tax shall be levied against all other parcels of Residential Land based on the anticipated number of Residences to be constructed thereon as determined by the City.

The Special Taxes of the District will be collected in the same manner and at the same time as ad valorem property taxes.

7. BACKGROUND INFORMATION

7.1. Project Description

The District was formed for the following purposes:

- To pay a portion of the cost of construction of a middle school located within the jurisdiction of the Mt. Diablo School District.
- To acquire certain site preparation work on the ball and playing field property conveyed to the City.

As of June 30, 2009, construction improvements have been completed.

7.2. Resolution

The resolution approved by the City Council authorizing the levy of the special tax was not available at the time of writing this report.

7.3. Boundary Map

The following page shows the boundaries of the District.



COMMUNITY FACILITIES DISTRICT NO. 1990-1R 2007 SPECIAL TAX REVENUE REFUNDING BONDS

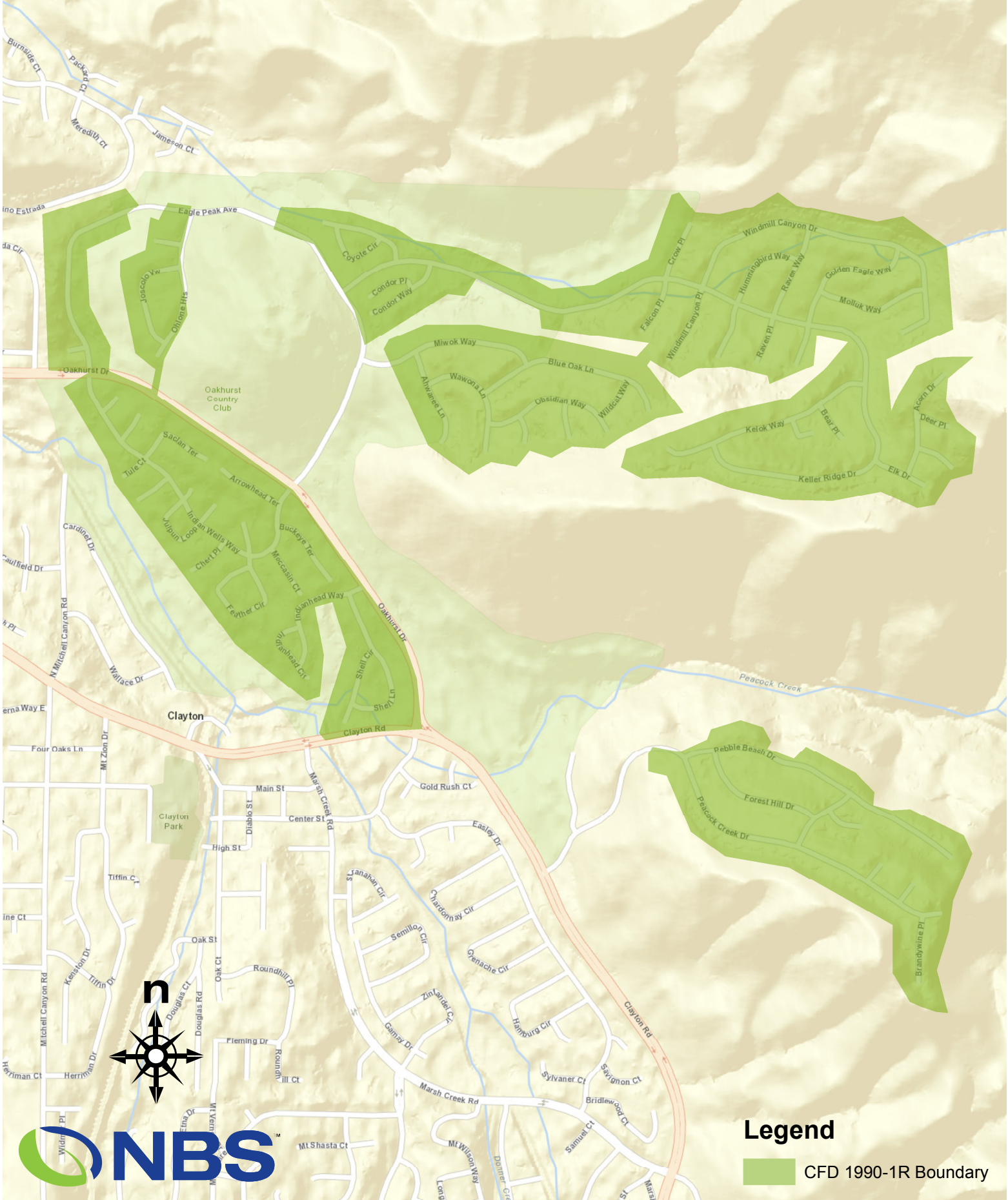

Legend
CFD 1990-1R Boundary

PROPOSED BOUNDARIES OF
COMMUNITY FACILITIES DISTRICT NO. 1990-1
 OF THE CITY OF CLAYTON,
 CONTRA COSTA COUNTY,
 STATE OF CALIFORNIA

MAY 1990
 TETRAD ENGINEERING
 PACHICO, CA.

FILED IN THE OFFICE OF THE CITY CLERK THIS 1ST DAY OF MAY, 1990.

MAY 1, 1990
 CITY CLERK - CITY OF CLAYTON

I HEREBY CERTIFY THAT THE WITHIN AND SHOWING PROPOSED BOUNDARIES
 OF COMMUNITY FACILITIES DISTRICT NO. 1990-1 OF THE CITY OF
 CLAYTON, CONTRA COSTA COUNTY, STATE OF CALIFORNIA, AS
 BY THE CITY COUNCIL OF THE CITY OF CLAYTON AT A PUBLIC HEARING
 HELD ON THE 1ST DAY OF MAY, 1990, BY ITS RESOLUTION NO.
 10-90.

MAY 1, 1990
 CITY CLERK - CITY OF CLAYTON

COUNTY CLERK STATEMENT
 FILED THIS DAY OF MAY 1990 AT THE HOUR OF
 10:00 A.M. IN THE OFFICE OF THE COUNTY CLERK OF THE COUNTY OF CONTRA COSTA, STATE OF CALIFORNIA.

EXHIBIT APPROVED BY COURT OF CONTRA COSTA

LEGEND

- (113) LOT NUMBER AS DESIGNATED ON TRACT 0988
- (118) LOT NUMBER AS DESIGNATED ON TRACT 0988 BUT
 SUBSEQUENTLY REDIVIDED
- (M.A.P.) NOT A PART (PARCEL TO BE EXCLUDED FROM ROLL 8000
 DISTRICT)

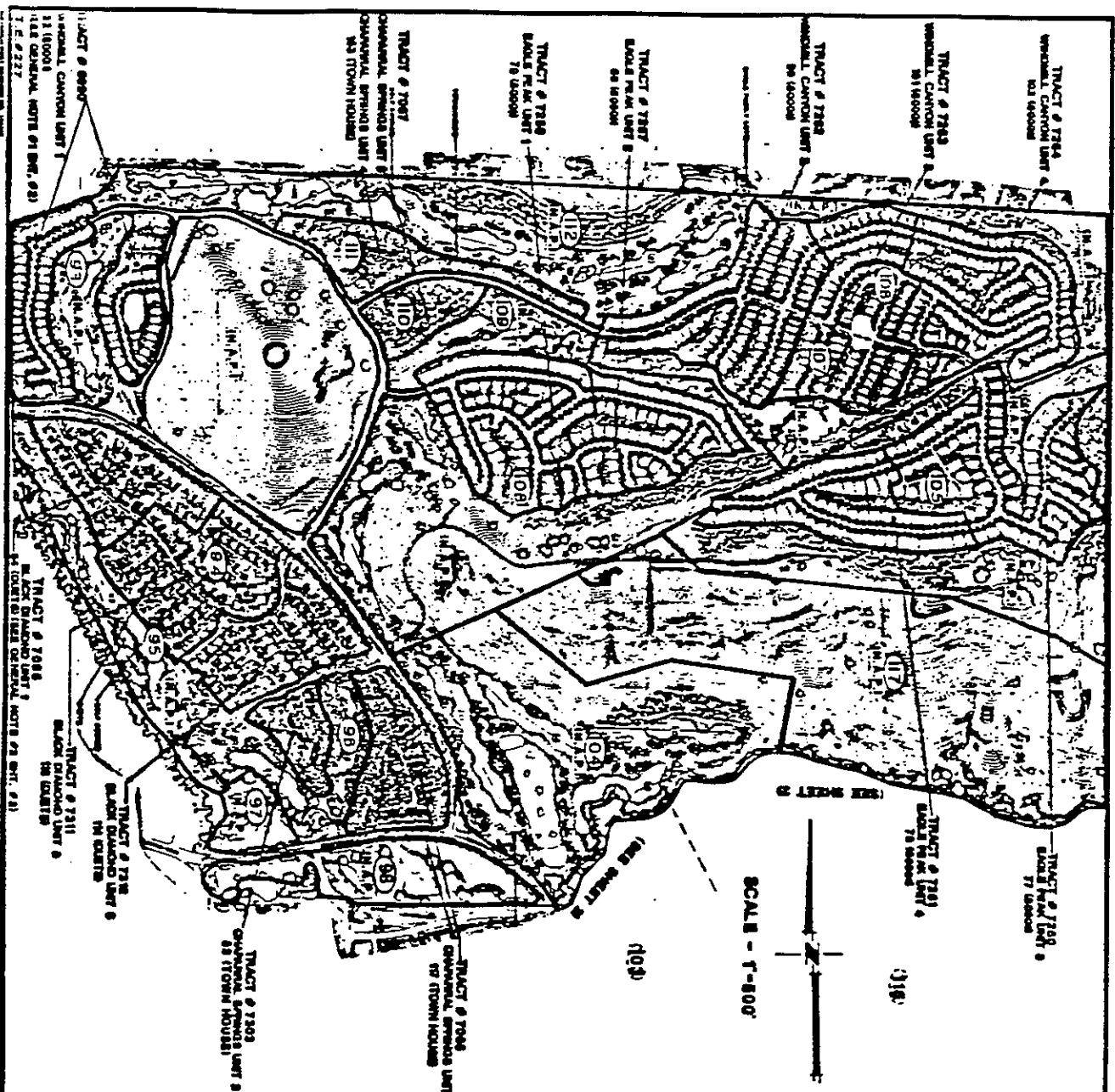

PROPOSED BOUNDARIES OF
COMMUNITY FACILITIES DISTRICT NO. 1990-1
 OF THE CITY OF CLAYTON,
 CONTRA COSTA COUNTY
 STATE OF CALIFORNIA

MAY 1990
 TETRAD ENGINEERING
 PACHECO, CA.

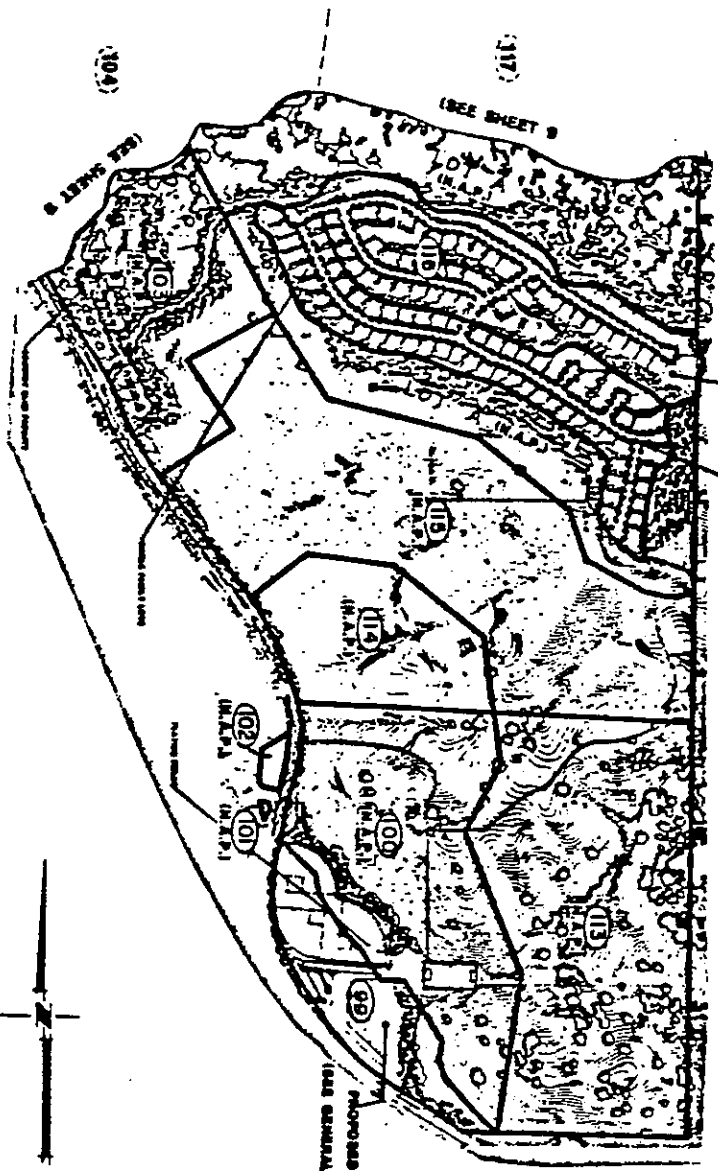

SCALE - 1"=500'

- (13) LOT NUMBER AS DESIGNATED ON TRACT 6888
- (10) LOT NUMBER AS DESIGNATED ON TRACT 6888 BUT SUBSEQUENTLY ACQUIRED
- (11) LOT A PART (PARCEL) TO BE EXCLUDED FROM WILLO MOON DISTRICT

1. THE FOLLOWING LOTS WITHIN WINDMILL CANYON UNIT 1 - TRACT 6888 ARE TO BE EXCLUDED FROM THE WILLO MOON DISTRICT:
 - LOTS 1 THROUGH 47 INCLUSIVE
 - 48 THROUGH 52 INCLUSIVE
 - 53 THROUGH 58 INCLUSIVE
 - 59 THROUGH 66 INCLUSIVE
2. THE FOLLOWING LOTS WITHIN SLACK DIAMOND UNIT NO. 1 - TRACT 1988 ARE TO BE EXCLUDED FROM THE WILLO MOON DISTRICT:
 - LOTS 11 THROUGH 18 INCLUSIVE
 - 19 THROUGH 26 INCLUSIVE
 - 27 THROUGH 30 INCLUSIVE
3. THE PROPOSED SCHOOL SITE WILL MOST LIKELY COMPRISE PORTIONS OF LOTS 59 AND 100 (TRACT 4920). A LOT LINE ADJUSTMENT ON PARCEL MAP WILL BE REQUESTED TO BE FILED TO ORIGINATE PARCEL OUT OF THE OUTSTANDING SCHOOL SITE PARCEL.
4. ALL OTHER SPACED PARCELS ARE TO BE EXCLUDED FROM THE WILLO MOON DISTRICT.
5. ALL GOLD CORNER PARCELS ARE TO BE EXCLUDED FROM THE WILLO MOON DISTRICT.
6. ALL CLUB HOUSE FACILITIES ARE TO BE EXCLUDED FROM THE WILLO MOON DISTRICT.
7. THE TOWN CENTER IS TO BE EXCLUDED FROM THE WILLO MOON DISTRICT.
8. THE FOLLOWING IS A TABULATION OF THE NUMBER OF UNITS TO BE EXCLUDED IN THE WILLO MOON DISTRICT.

TRACT NAME	TRACT NO.	NO. OF UNITS	TRACT AREA
WINDMILL CANYON UNIT 1	6888	22	6009 ± LOTS
WINDMILL CANYON UNIT 2	7248	88	6009 ± LOTS
WINDMILL CANYON UNIT 3	7248	151	6009 ± LOTS
WINDMILL CANYON UNIT 4	7248	103	6009 ± LOTS
SLACK PEAK UNIT 1	7248	19	6009 ± LOTS
SLACK PEAK UNIT 2	7248	68	6009 ± LOTS
SLACK PEAK UNIT 3	7248	77	6009 ± LOTS
SLACK PEAK UNIT 4	7248	78	6009 ± LOTS
SLACK DIAMOND UNIT 1	1988	14	CLUBS
SLACK DIAMOND UNIT 2	1988	13	CLUBS
SLACK DIAMOND UNIT 3	1988	14	CLUBS
SLACK DIAMOND UNIT 4	1988	13	CLUBS
SLACK DIAMOND UNIT 5	1988	13	CLUBS
SLACK DIAMOND UNIT 6	1988	13	CLUBS
SLACK DIAMOND UNIT 7	1988	13	CLUBS
SLACK DIAMOND UNIT 8	1988	13	CLUBS
SLACK DIAMOND UNIT 9	1988	13	CLUBS
SLACK DIAMOND UNIT 10	1988	13	CLUBS
SLACK DIAMOND UNIT 11	1988	13	CLUBS
SLACK DIAMOND UNIT 12	1988	13	CLUBS
SLACK DIAMOND UNIT 13	1988	13	CLUBS
SLACK DIAMOND UNIT 14	1988	13	CLUBS
SLACK DIAMOND UNIT 15	1988	13	CLUBS
SLACK DIAMOND UNIT 16	1988	13	CLUBS
SLACK DIAMOND UNIT 17	1988	13	CLUBS
SLACK DIAMOND UNIT 18	1988	13	CLUBS
SLACK DIAMOND UNIT 19	1988	13	CLUBS
SLACK DIAMOND UNIT 20	1988	13	CLUBS
SLACK DIAMOND UNIT 21	1988	13	CLUBS
SLACK DIAMOND UNIT 22	1988	13	CLUBS
SLACK DIAMOND UNIT 23	1988	13	CLUBS
SLACK DIAMOND UNIT 24	1988	13	CLUBS
SLACK DIAMOND UNIT 25	1988	13	CLUBS
SLACK DIAMOND UNIT 26	1988	13	CLUBS
SLACK DIAMOND UNIT 27	1988	13	CLUBS
SLACK DIAMOND UNIT 28	1988	13	CLUBS
SLACK DIAMOND UNIT 29	1988	13	CLUBS
SLACK DIAMOND UNIT 30	1988	13	CLUBS
SLACK DIAMOND UNIT 31	1988	13	CLUBS
SLACK DIAMOND UNIT 32	1988	13	CLUBS
SLACK DIAMOND UNIT 33	1988	13	CLUBS
SLACK DIAMOND UNIT 34	1988	13	CLUBS
SLACK DIAMOND UNIT 35	1988	13	CLUBS
SLACK DIAMOND UNIT 36	1988	13	CLUBS
SLACK DIAMOND UNIT 37	1988	13	CLUBS
SLACK DIAMOND UNIT 38	1988	13	CLUBS
SLACK DIAMOND UNIT 39	1988	13	CLUBS
SLACK DIAMOND UNIT 40	1988	13	CLUBS
SLACK DIAMOND UNIT 41	1988	13	CLUBS
SLACK DIAMOND UNIT 42	1988	13	CLUBS
SLACK DIAMOND UNIT 43	1988	13	CLUBS
SLACK DIAMOND UNIT 44	1988	13	CLUBS
SLACK DIAMOND UNIT 45	1988	13	CLUBS
SLACK DIAMOND UNIT 46	1988	13	CLUBS
SLACK DIAMOND UNIT 47	1988	13	CLUBS
SLACK DIAMOND UNIT 48	1988	13	CLUBS
SLACK DIAMOND UNIT 49	1988	13	CLUBS
SLACK DIAMOND UNIT 50	1988	13	CLUBS
SLACK DIAMOND UNIT 51	1988	13	CLUBS
SLACK DIAMOND UNIT 52	1988	13	CLUBS
SLACK DIAMOND UNIT 53	1988	13	CLUBS
SLACK DIAMOND UNIT 54	1988	13	CLUBS
SLACK DIAMOND UNIT 55	1988	13	CLUBS
SLACK DIAMOND UNIT 56	1988	13	CLUBS
SLACK DIAMOND UNIT 57	1988	13	CLUBS
SLACK DIAMOND UNIT 58	1988	13	CLUBS
SLACK DIAMOND UNIT 59	1988	13	CLUBS
SLACK DIAMOND UNIT 60	1988	13	CLUBS
SLACK DIAMOND UNIT 61	1988	13	CLUBS
SLACK DIAMOND UNIT 62	1988	13	CLUBS
SLACK DIAMOND UNIT 63	1988	13	CLUBS
SLACK DIAMOND UNIT 64	1988	13	CLUBS
SLACK DIAMOND UNIT 65	1988	13	CLUBS
SLACK DIAMOND UNIT 66	1988	13	CLUBS
SLACK DIAMOND UNIT 67	1988	13	CLUBS
SLACK DIAMOND UNIT 68	1988	13	CLUBS
SLACK DIAMOND UNIT 69	1988	13	CLUBS
SLACK DIAMOND UNIT 70	1988	13	CLUBS
SLACK DIAMOND UNIT 71	1988	13	CLUBS
SLACK DIAMOND UNIT 72	1988	13	CLUBS
SLACK DIAMOND UNIT 73	1988	13	CLUBS
SLACK DIAMOND UNIT 74	1988	13	CLUBS
SLACK DIAMOND UNIT 75	1988	13	CLUBS
SLACK DIAMOND UNIT 76	1988	13	CLUBS
SLACK DIAMOND UNIT 77	1988	13	CLUBS
SLACK DIAMOND UNIT 78	1988	13	CLUBS
SLACK DIAMOND UNIT 79	1988	13	CLUBS
SLACK DIAMOND UNIT 80	1988	13	CLUBS
SLACK DIAMOND UNIT 81	1988	13	CLUBS
SLACK DIAMOND UNIT 82	1988	13	CLUBS
SLACK DIAMOND UNIT 83	1988	13	CLUBS
SLACK DIAMOND UNIT 84	1988	13	CLUBS
SLACK DIAMOND UNIT 85	1988	13	CLUBS
SLACK DIAMOND UNIT 86	1988	13	CLUBS
SLACK DIAMOND UNIT 87	1988	13	CLUBS
SLACK DIAMOND UNIT 88	1988	13	CLUBS
SLACK DIAMOND UNIT 89	1988	13	CLUBS
SLACK DIAMOND UNIT 90	1988	13	CLUBS
SLACK DIAMOND UNIT 91	1988	13	CLUBS
SLACK DIAMOND UNIT 92	1988	13	CLUBS
SLACK DIAMOND UNIT 93	1988	13	CLUBS
SLACK DIAMOND UNIT 94	1988	13	CLUBS
SLACK DIAMOND UNIT 95	1988	13	CLUBS
SLACK DIAMOND UNIT 96	1988	13	CLUBS
SLACK DIAMOND UNIT 97	1988	13	CLUBS
SLACK DIAMOND UNIT 98	1988	13	CLUBS
SLACK DIAMOND UNIT 99	1988	13	CLUBS
SLACK DIAMOND UNIT 100	1988	13	CLUBS

8. DELINQUENCY DETAIL

The following pages detail delinquencies for the 2016/17 and prior fiscal years.

City of Clayton
Community Facilities District 1990-1R
Delinquency Detail Report

Late Charges Calculated Through: 06/07/2017

Account ID	Owner	Due Date	Amount	Penalties	Fees (1)	Total	Delinquency Mgmt (2)	Misc (3)
118-401-042	KWOCK-LAU JENNIFER 401 CHUPCAN PL CLAYTON, CA 94517	12/10/2016	117.99	11.80	0.00	129.79	RL	
		04/10/2017	117.99	11.80	0.00	129.79	RL	
Account Subtotal:			\$235.98	\$23.60	\$0.00	\$259.58		
118-410-069	NICKEL WENDY 1278 SHELL CIR CLAYTON, CA 94517	04/10/2017	95.81	9.58	0.00	105.39		
		Account Subtotal:			\$95.81	\$9.58	\$0.00	\$105.39
118-410-090	MOYLAN JAMES F JR 1336 SHELL LN CLAYTON, CA 94517	12/10/2016	95.81	9.58	0.00	105.39	RL	
		04/10/2017	95.81	9.58	0.00	105.39	RL	
Account Subtotal:			\$191.62	\$19.16	\$0.00	\$210.78		
118-410-104	BILLO WILLIAM F & YVONNE R TRE 1368 SHELL LN CLAYTON, CA 94517	12/10/2016	95.81	9.58	0.00	105.39	RL	
		04/10/2017	95.81	9.58	0.00	105.39	RL	
Account Subtotal:			\$191.62	\$19.16	\$0.00	\$210.78		
118-441-023	TAYLOR BARBARA LERCH TRE 113 CROW PL CLAYTON, CA 94517	04/10/2017	137.28	13.73	0.00	151.01		
		Account Subtotal:			\$137.28	\$13.73	\$0.00	\$151.01
118-451-004	RIVERA ROBERT A & ROBYN O TRE 307 WINDMILL CANYON PL CLAYTON, CA 94517	04/10/2017	137.28	13.73	0.00	151.01		
		Account Subtotal:			\$137.28	\$13.73	\$0.00	\$151.01

(1) Fees: This amount excludes Delinquency Management fees that were or will be collected in a subsequent billing.

(2) Delinquency Management (DM): RL=Reminder Letter Sent; DL=Demand Letter Sent; SR=Tax Roll Removal Requested; SC=Tax Roll Removal Confirmed; FL=Foreclosure Letter Sent; OL=Other Letter Sent; FI=Judicial Foreclosure Initiated; CP=County Payment Plan; FH=Judicial Foreclosure on Hold/Special Case; FC=Foreclosure Complete; LIT=Litigation Guarantee; LGL=Legal Fees and Costs; O=Other Fees; SO=Tax Roll Removal County Fee; PP=Payment Plan.

(3) Miscellaneous Codes: DB=Direct Bill Sent; BK=Declared Bankruptcy; PM=Partial Payment made, remainder delinquent.

City of Clayton
Community Facilities District 1990-1R
Delinquency Detail Report

Late Charges Calculated Through: 06/07/2017

Account ID	Owner	Due Date	Amount	Penalties	Fees (1)	Total	Delinquency Mgmt (2)	Misc (3)
118-460-005	KHAN FAROOQ H 608 JLPUN LOOP CLAYTON, CA 94517	12/10/2016	117.99	11.80	0.00	129.79	RL	
		04/10/2017	117.99	11.80	0.00	129.79	RL	
Account Subtotal:			\$235.98	\$23.60	\$0.00	\$259.58		
118-460-069	MALTBIE JOAN C TRE 1725 INDIAN WELLS WAY CLAYTON, CA 94517	04/10/2017	117.99	11.80	0.00	129.79		
		Account Subtotal:			\$117.99	\$11.80	\$0.00	\$129.79
118-470-036	GUERRETTAZ RYAN & CAROLINE 1151 MOCCASIN CT CLAYTON, CA 94517	04/10/2017	117.99	11.80	0.00	129.79		
		Account Subtotal:			\$117.99	\$11.80	\$0.00	\$129.79
118-470-069	DEY JYOTIRMOY & SRIRANJINI 1015 FEATHER CIR CLAYTON, CA 94517	04/10/2017	117.99	11.80	0.00	129.79		
		Account Subtotal:			\$117.99	\$11.80	\$0.00	\$129.79
118-480-024	WILLIAMS CHRISTOPHER L TRE 1010 PEBBLE BEACH DR CLAYTON, CA 94517	04/10/2017	238.72	23.87	0.00	262.59	RL	
		Account Subtotal:			\$238.72	\$23.87	\$0.00	\$262.59
118-500-031	QURESHI MOHAMMAD NAYEEM TRE 1103 PEACOCK CREEK DR CLAYTON, CA 94517	04/10/2017	238.72	23.87	0.00	262.59	RL	
		Account Subtotal:			\$238.72	\$23.87	\$0.00	\$262.59
118-510-023	CHIN WARREN H & JILL K PO BOX 946 CLAYTON, CA 94517	04/10/2017	238.72	23.87	0.00	262.59	RL	
		Account Subtotal:			\$238.72	\$23.87	\$0.00	\$262.59

(1) Fees: This amount excludes Delinquency Management fees that were or will be collected in a subsequent billing.

(2) Delinquency Management (DM): RL=Reminder Letter Sent; DL=Demand Letter Sent; SR=Tax Roll Removal Requested; SC=Tax Roll Removal Confirmed; FL=Foreclosure Letter Sent; OL=Other Letter Sent; FI=Judicial Foreclosure Initiated; CP=County Payment Plan; FH=Judicial Foreclosure on Hold/Special Case; FC=Foreclosure Complete; LIT=Litigation Guarantee; LGL=Legal Fees and Costs; O=Other Fees; SO=Tax Roll Removal County Fee; PP=Payment Plan.

(3) Miscellaneous Codes: DB=Direct Bill Sent; BK=Declared Bankruptcy; PM=Partial Payment made, remainder delinquent.

City of Clayton
Community Facilities District 1990-1R
Delinquency Detail Report

Late Charges Calculated Through: 06/07/2017

Account ID	Owner	Due Date	Amount	Penalties	Fees (1)	Total	Delinquency Mgmt (2)	Misc (3)
118-510-031	LALLY KENNETH & KIM 163 SILVERADO CT CLAYTON, CA 94517	04/10/2017	238.72	23.87	0.00	262.59	RL	
Account Subtotal:			\$238.72	\$23.87	\$0.00	\$262.59		
118-530-016	BECK SUSAN M 1431 INDIANHEAD WAY CLAYTON, CA 94517	12/10/2012 04/10/2013	108.92 108.92	89.31 89.31	0.00 0.00	198.23 198.23	RL,DL RL,DL	
Account Subtotal:			\$217.84	\$178.62	\$0.00	\$396.46		
118-530-043	SHIPMAN TANA G TRE 1485 INDIANHEAD CIR CLAYTON, CA 94517	12/10/2016 04/10/2017	95.81 95.81	9.58 9.58	0.00 0.00	105.39 105.39	DL DL	
Account Subtotal:			\$191.62	\$19.16	\$0.00	\$210.78		
118-540-014	HOWARD DONALD & DEBORAH TRE 4014 HUMMINGBIRD WAY CLAYTON, CA 94517	12/10/2015 04/10/2016	138.65 138.65	38.82 38.82	0.00 0.00	177.47 177.47	RL,DL RL,DL	
Account Subtotal:			\$277.30	\$77.64	\$0.00	\$354.94		
118-550-010	WEBSTER DAVID S & CURRY MICHELLE 507 RAVEN PL CLAYTON, CA 94517	04/10/2017	137.28	13.73	0.00	151.01		
Account Subtotal:			\$137.28	\$13.73	\$0.00	\$151.01		
118-570-029	KING JON B & STACY L 65 ANTELOPE CT CLAYTON, CA 94517	04/10/2017	205.12	20.51	0.00	225.63		
Account Subtotal:			\$205.12	\$20.51	\$0.00	\$225.63		
118-580-013	EBBINK WILLIAM J & KEETON EDITH F 224 CONDOR WAY CLAYTON, CA 94517	04/10/2017	117.99	11.80	0.00	129.79		
Account Subtotal:			\$117.99	\$11.80	\$0.00	\$129.79		

(1) Fees: This amount excludes Delinquency Management fees that were or will be collected in a subsequent billing.

(2) Delinquency Management (DM): RL=Reminder Letter Sent; DL=Demand Letter Sent; SR=Tax Roll Removal Requested; SC=Tax Roll Removal Confirmed; FL=Foreclosure Letter Sent; OL=Other Letter Sent; FI=Judicial Foreclosure Initiated; CP=County Payment Plan; FH=Judicial Foreclosure on Hold/Special Case; FC=Foreclosure Complete; LIT=Litigation Guarantee; LGL=Legal Fees and Costs; O=Other Fees; SO=Tax Roll Removal County Fee; PP=Payment Plan.

(3) Miscellaneous Codes: DB=Direct Bill Sent; BK=Declared Bankruptcy; PM=Partial Payment made, remainder delinquent.

City of Clayton
Community Facilities District 1990-1R
Delinquency Detail Report

Late Charges Calculated Through: 06/07/2017

Account ID	Owner	Due Date	Amount	Penalties	Fees (1)	Total	Delinquency Mgmt (2)	Misc (3)
118-590-030	RIGOLI DANIEL A & DIANA M 4801 KELLER RIDGE DR CLAYTON, CA 94517	04/10/2017	95.81	9.58	0.00	105.39		
		Account Subtotal:	\$95.81	\$9.58	\$0.00	\$105.39		
118-600-018	SMITH DAVID G & ALYSE M 601 CONDOR PL CLAYTON, CA 94517	04/10/2017	95.81	9.58	0.00	105.39		
		Account Subtotal:	\$95.81	\$9.58	\$0.00	\$105.39		
118-620-008	SKOV BARBARA A TRE 41780 BUTTERFIELD STAGE RD TEMECULA, CA 92592	04/10/2017	137.28	13.73	0.00	151.01		
		Account Subtotal:	\$137.28	\$13.73	\$0.00	\$151.01		
118-620-026	COLT SAMUEL T & CATHERINE L 6024 GOLDEN EAGLE WAY CLAYTON, CA 94517	04/10/2017	137.28	13.73	0.00	151.01		
		Account Subtotal:	\$137.28	\$13.73	\$0.00	\$151.01		
118-670-017	LUO ANDREW 3814 TWIN FALLS CT SAN JOSE, CA 95121	04/10/2017	205.12	20.51	0.00	225.63		
		Account Subtotal:	\$205.12	\$20.51	\$0.00	\$225.63		
District Totals:	25 Accounts		\$4,352.87	\$642.03	\$0.00	\$4,994.90		
Report Totals:	25 Accounts		\$4,352.87	\$642.03	\$0.00	\$4,994.90		

(1) Fees: This amount excludes Delinquency Management fees that were or will be collected in a subsequent billing.

(2) Delinquency Management (DM): RL=Reminder Letter Sent; DL=Demand Letter Sent; SR=Tax Roll Removal Requested; SC=Tax Roll Removal Confirmed; FL=Foreclosure Letter Sent; OL=Other Letter Sent; FI=Judicial Foreclosure Initiated; CP=County Payment Plan; FH=Judicial Foreclosure on Hold/Special Case; FC=Foreclosure Complete; LIT=Litigation Guarantee; LGL=Legal Fees and Costs; O=Other Fees; SO=Tax Roll Removal County Fee; PP=Payment Plan.

(3) Miscellaneous Codes: DB=Direct Bill Sent; BK=Declared Bankruptcy; PM=Partial Payment made, remainder delinquent.

9. 2017/18 SPECIAL TAX ROLL

The following pages provide the 2017/18 Special Tax Roll for the District.



City of Clayton
Community Facilities District 1990-1R
Clayton Middle School
Fiscal Year 2017/18 Special Tax Roll

APN	Situs Address	Levy
118-382-015	1828 EAGLE PEAK AVE	\$271.82
118-382-016	1824 EAGLE PEAK AVE	271.82
118-382-017	1820 EAGLE PEAK AVE	271.82
118-382-018	1816 EAGLE PEAK AVE	271.82
118-382-019	1812 EAGLE PEAK AVE	271.82
118-382-020	1808 EAGLE PEAK AVE	271.82
118-382-021	1804 EAGLE PEAK AVE	271.82
118-382-022	1800 EAGLE PEAK AVE	271.82
118-391-018	136 JOSCOLO VIEW	271.82
118-391-024	160 JOSCOLO VIEW	271.82
118-392-001	1816 OHLONE HEIGHTS	271.82
118-392-002	1820 OHLONE HEIGHTS	271.82
118-392-003	1824 OHLONE HEIGHTS	271.82
118-392-004	1828 OHLONE HTS	271.82
118-392-005	1832 OHLONE HEIGHTS	271.82
118-392-006	1836 OHLONE HEIGHTS	271.82
118-392-007	1840 OHLONE HEIGHTS	271.82
118-392-012	129 JOSCOLO VIEW	271.82
118-392-014	135 JOSCOLO VIEW	271.82
118-392-015	139 JOSCOLO VIEW	271.82
118-392-016	145 JOSCOLO VIEW	271.82
118-401-001	1790 INDIAN WELLS WAY	233.64
118-401-002	1788 INDIAN WELLS WAY	233.64
118-401-003	1786 INDIAN WELLS WAY	233.64
118-401-004	1784 INDIAN WELLS WAY	233.64
118-401-005	1782 INDIAN WELLS WAY	233.64
118-401-006	1780 INDIAN WELLS WAY	233.64
118-401-007	1778 INDIAN WELLS WAY	233.64
118-401-008	1776 INDIAN WELLS WAY	233.64
118-401-009	1774 INDIAN WELLS WAY	233.64
118-401-010	1772 INDIAN WELLS WAY	233.64
118-401-019	40 TULE CT	233.64
118-401-029	400 CHUPCAN PL	233.64
118-401-030	402 CHUPCAN PL	233.64
118-401-031	404 CHUPCAN PL	233.64
118-401-032	406 CHUPCAN PL	233.64
118-401-033	408 CHUPCAN PL	233.64
118-401-034	410 CHUPCAN PL	233.64
118-401-035	417 CHUPCAN PL	233.64
118-401-036	415 CHUPCAN PL	233.64



City of Clayton
Community Facilities District 1990-1R
Clayton Middle School
Fiscal Year 2017/18 Special Tax Roll

APN	Situs Address	Levy
118-401-037	411 CHUPCAN PL	233.64
118-401-038	409 CHUPCAN PL	233.64
118-401-039	407 CHUPCAN PL	233.64
118-401-040	405 CHUPCAN PL	233.64
118-401-041	403 CHUPCAN PL	233.64
118-401-042	401 CHUPCAN PL	233.64
118-402-001	1735 INDIAN WELLS WAY	233.64
118-402-002	1737 INDIAN WELLS WAY	233.64
118-402-003	1739 INDIAN WELLS WAY	233.64
118-402-004	1741 INDIAN WELLS WAY	233.64
118-402-005	1743 INDIAN WELLS WAY	233.64
118-402-006	1745 INDIAN WELLS WAY	233.64
118-402-007	1747 INDIAN WELLS WAY	233.64
118-402-008	1749 INDIAN WELLS WAY	233.64
118-402-009	310 SACLAN TERRACE PL	233.64
118-402-010	320 SACLAN TERRACE PL	233.64
118-402-011	326 SACLAN TERRACE PL	233.64
118-402-012	328 SACLAN TERRACE PL	233.64
118-402-013	330 SACLAN TERRACE PL	233.64
118-402-014	332 SACLAN TERRACE PL	233.64
118-402-015	334 SACLAN TERRACE PL	233.64
118-402-016	336 SACLAN TERRACE PL	233.64
118-402-017	338 SACLAN TERRACE PL	233.64
118-402-018	340 SACLAN TERRACE PL	233.64
118-402-019	341 SACLAN TERRACE PL	233.64
118-402-020	339 SACLAN TERRACE PL	233.64
118-402-021	337 SACLAN TERRACE PL	233.64
118-402-022	335 SACLAN TERRACE PL	233.64
118-402-023	333 SACLAN TERRACE PL	233.64
118-402-024	331 SACLAN TERRACE PL	233.64
118-402-025	329 SACLAN TERRACE PL	233.64
118-402-026	327 SACLAN TERRACE PL	233.64
118-402-027	325 SACLAN TERRACE PL	233.64
118-402-028	323 SACLAN TERRACE PL	233.64
118-402-029	321 SACLAN TERRACE PL	233.64
118-410-001	1399 SHELL LN	189.70
118-410-002	1397 SHELL LN	189.70
118-410-003	1389 SHELL LN	189.70
118-410-004	1387 SHELL LN	189.70
118-410-005	1385 SHELL LN	189.70



City of Clayton
Community Facilities District 1990-1R
Clayton Middle School
Fiscal Year 2017/18 Special Tax Roll

APN	Situs Address	Levy
118-410-006	1383 SHELL LN	189.70
118-410-007	1381 SHELL LN	189.70
118-410-008	1379 SHELL LN	189.70
118-410-009	1377 SHELL LN	189.70
118-410-010	1375 SHELL LN	189.70
118-410-011	1373 SHELL LN	189.70
118-410-012	1371 SHELL LN	189.70
118-410-013	1369 SHELL LN	189.70
118-410-014	1367 SHELL LN	189.70
118-410-015	1365 SHELL LN	189.70
118-410-016	1363 SHELL LN	189.70
118-410-017	1361 SHELL LN	189.70
118-410-018	1359 SHELL LN	189.70
118-410-019	1357 SHELL LN	189.70
118-410-020	1355 SHELL LN	189.70
118-410-021	1353 SHELL LN	189.70
118-410-022	1351 SHELL LN	189.70
118-410-023	1349 SHELL LN	189.70
118-410-024	1347 SHELL LN	189.70
118-410-025	1345 SHELL LN	189.70
118-410-026	1343 SHELL LN	189.70
118-410-027	1341 SHELL LN	189.70
118-410-028	1339 SHELL LN	189.70
118-410-029	1337 SHELL LN	189.70
118-410-030	1335 SHELL LN	189.70
118-410-031	1333 SHELL LN	189.70
118-410-032	1331 SHELL LN	189.70
118-410-033	1329 SHELL LN	189.70
118-410-034	1327 SHELL LN	189.70
118-410-035	1199 SHELL LN	189.70
118-410-037	1195 SHELL LN	189.70
118-410-038	1193 SHELL LN	189.70
118-410-039	1191 SHELL LN	189.70
118-410-040	1189 SHELL LN	189.70
118-410-041	1187 SHELL LN	189.70
118-410-042	1185 SHELL LN	189.70
118-410-043	1183 SHELL LN	189.70
118-410-044	1181 SHELL LN	189.70
118-410-045	1179 SHELL LN	189.70
118-410-046	1177 SHELL LN	189.70



City of Clayton
Community Facilities District 1990-1R
Clayton Middle School
Fiscal Year 2017/18 Special Tax Roll

APN	Situs Address	Levy
118-410-047	1175 SHELL LN	189.70
118-410-048	1173 SHELL LN	189.70
118-410-049	1171 SHELL LN	189.70
118-410-050	1169 SHELL LN	189.70
118-410-051	1167 SHELL LN	189.70
118-410-052	1267 SHELL CIR	189.70
118-410-053	1265 SHELL CIR	189.70
118-410-054	1263 SHELL CIR	189.70
118-410-055	1261 SHELL CIR	189.70
118-410-056	1259 SHELL CIR	189.70
118-410-057	1254 SHELL CIR	189.70
118-410-058	1256 SHELL CIR	189.70
118-410-059	1258 SHELL CIR	189.70
118-410-060	1260 SHELL CIR	189.70
118-410-061	1262 SHELL CIR	189.70
118-410-062	1264 SHELL CIR	189.70
118-410-063	1266 SHELL CIR	189.70
118-410-064	1268 SHELL CIR	189.70
118-410-065	1270 SHELL CIR	189.70
118-410-066	1272 SHELL CIR	189.70
118-410-067	1274 SHELL CIR	189.70
118-410-068	1276 SHELL CIR	189.70
118-410-069	1278 SHELL CIR	189.70
118-410-070	1280 SHELL CIR	189.70
118-410-071	1282 SHELL CIR	189.70
118-410-072	1284 SHELL CIR	189.70
118-410-073	1286 SHELL CIR	189.70
118-410-074	1288 SHELL CIR	189.70
118-410-075	1290 SHELL CIR	189.70
118-410-076	1292 SHELL CIR	189.70
118-410-077	1294 SHELL CIR	189.70
118-410-078	1296 SHELL CIR	189.70
118-410-079	1298 SHELL CIR	189.70
118-410-080	1269 SHELL CIR	189.70
118-410-081	1271 SHELL CIR	189.70
118-410-082	1273 SHELL CIR	189.70
118-410-083	1275 SHELL CIR	189.70
118-410-084	1332 SHELL LN	189.70
118-410-085	1330 SHELL LN	189.70
118-410-086	1328 SHELL LN	189.70



City of Clayton
Community Facilities District 1990-1R
Clayton Middle School
Fiscal Year 2017/18 Special Tax Roll

APN	Situs Address	Levy
118-410-087	1326 SHELL LN	189.70
118-410-088	1340 SHELL LN	189.70
118-410-089	1338 SHELL LN	189.70
118-410-090	1336 SHELL LN	189.70
118-410-091	1334 SHELL LN	189.70
118-410-092	1277 SHELL CIR	189.70
118-410-093	1279 SHELL CIR	189.70
118-410-094	1281 SHELL CIR	189.70
118-410-095	1283 SHELL CIR	189.70
118-410-096	1285 SHELL CIR	189.70
118-410-097	1287 SHELL CIR	189.70
118-410-098	1289 SHELL CIR	189.70
118-410-099	1291 SHELL CIR	189.70
118-410-100	1293 SHELL CIR	189.70
118-410-101	1295 SHELL CIR	189.70
118-410-102	1297 SHELL CIR	189.70
118-410-103	1299 SHELL CIR	189.70
118-410-104	1368 SHELL LN	189.70
118-410-105	1370 SHELL LN	189.70
118-410-106	1372 SHELL LN	189.70
118-410-107	1374 SHELL LN	189.70
118-410-108	1376 SHELL LN	189.70
118-410-109	1378 SHELL LN	189.70
118-410-110	1380 SHELL LN	189.70
118-410-111	1382 SHELL LN	189.70
118-410-112	1388 SHELL LN	189.70
118-410-113	1390 SHELL LN	189.70
118-410-114	1392 SHELL LN	189.70
118-410-115	1394 SHELL LN	189.70
118-410-116	1396 SHELL LN	189.70
118-410-117	1398 SHELL LN	189.70
118-410-120	1197 SHELL LN	189.70
118-421-001	304 AHWANEE LN	406.16
118-421-002	308 AHWANEE LN	406.16
118-421-003	312 AHWANEE LN	406.16
118-422-001	451 OBSIDIAN WAY	406.16
118-422-002	350 BLUE OAK LN	406.16
118-422-003	352 BLUE OAK LN	406.16
118-422-004	354 BLUE OAK LN	406.16
118-422-005	356 BLUE OAK LN	406.16



City of Clayton
Community Facilities District 1990-1R
Clayton Middle School
Fiscal Year 2017/18 Special Tax Roll

APN	Situs Address	Levy
118-422-006	358 BLUE OAK LN	406.16
118-422-007	360 BLUE OAK LN	406.16
118-423-001	361 BLUE OAK LN	406.16
118-423-002	3057 MIWOK WAY	406.16
118-423-003	3055 MIWOK WAY	406.16
118-423-004	3053 MIWOK WAY	406.16
118-423-005	3051 MIWOK WAY	406.16
118-423-006	3049 MIWOK WAY	406.16
118-423-007	3047 MIWOK WAY	406.16
118-423-008	3045 MIWOK WAY	406.16
118-423-009	3043 MIWOK WAY	406.16
118-423-010	3041 MIWOK WAY	406.16
118-423-011	3039 MIWOK WAY	406.16
118-423-012	3037 MIWOK WAY	406.16
118-423-013	3035 MIWOK WAY	406.16
118-423-014	3033 MIWOK WAY	406.16
118-423-015	3031 MIWOK WAY	406.16
118-424-001	359 BLUE OAK LN	406.16
118-424-002	357 BLUE OAK LN	406.16
118-424-003	355 BLUE OAK LN	406.16
118-424-004	353 BLUE OAK LN	406.16
118-424-005	351 BLUE OAK LN	406.16
118-424-006	409 WAWONA LN	406.16
118-424-007	407 WAWONA LN	406.16
118-424-008	405 WAWONA LN	406.16
118-424-009	403 WAWONA LN	406.16
118-424-010	401 WAWONA LN	406.16
118-424-011	3034 MIWOK WAY	406.16
118-424-012	3038 MIWOK WAY	406.16
118-424-013	3040 MIWOK WAY	406.16
118-424-014	3042 MIWOK WAY	406.16
118-424-015	3046 MIWOK WAY	406.16
118-424-016	3048 MIWOK WAY	406.16
118-424-017	3050 MIWOK WAY	406.16
118-424-018	3052 MIWOK WAY	406.16
118-424-019	3054 MIWOK WAY	406.16
118-431-001	316 AHWANEE CT	406.16
118-431-002	320 AHWANEE CT	406.16
118-431-003	324 AHWANEE CT	406.16
118-431-004	328 AHWANEE CT	406.16



City of Clayton
Community Facilities District 1990-1R
Clayton Middle School
Fiscal Year 2017/18 Special Tax Roll

APN	Situs Address	Levy
118-431-005	332 AHWANEE CT	406.16
118-432-002	333 AHWANEE LN	406.16
118-432-003	329 AHWANEE LN	406.16
118-432-004	325 AHWANEE LN	406.16
118-432-005	321 AHWANEE CT	406.16
118-432-006	317 AHWANEE CT	406.16
118-432-007	400 WAWONA LN	406.16
118-432-008	402 WAWONA LN	406.16
118-432-009	404 WAWONA LN	406.16
118-432-010	406 WAWONA LN	406.16
118-432-011	408 WAWONA LN	406.16
118-432-012	410 WAWONA LN	406.16
118-432-013	412 WAWONA LN	406.16
118-432-014	414 WAWONA LN	406.16
118-432-015	416 WAWONA CT	406.16
118-432-016	418 WAWONA LN	406.16
118-432-017	420 WAWONA CT	406.16
118-432-019	337 AHWANEE CT	406.16
118-432-020	422 WAWONA LN	406.16
118-433-002	419 WAWONA LN	406.16
118-433-003	417 WAWONA CT	406.16
118-433-004	421 WAWONA CT	406.16
118-441-001	5101 KELLER RIDGE DR	271.82
118-441-002	5103 KELLER RIDGE DR	271.82
118-441-003	5105 KELLER RIDGE DR	271.82
118-441-004	5107 KELLER RIDGE DR	271.82
118-441-005	5109 KELLER RIDGE DR	271.82
118-441-007	5113 KELLER RIDGE DR	271.82
118-441-008	5115 KELLER RIDGE DR	271.82
118-441-009	5117 KELLER RIDGE DR	271.82
118-441-010	5119 KELLER RIDGE DR	271.82
118-441-011	5121 KELLER RIDGE DR	271.82
118-441-012	5123 KELLER RIDGE DR	271.82
118-441-013	5125 KELLER RIDGE DR	271.82
118-441-014	5127 KELLER RIDGE DR	271.82
118-441-015	5129 KELLER RIDGE DR	271.82
118-441-016	5131 KELLER RIDGE DR	271.82
118-441-017	101 CROW PL	271.82
118-441-018	103 CROW PL	271.82
118-441-019	105 CROW PL	271.82



City of Clayton
Community Facilities District 1990-1R
Clayton Middle School
Fiscal Year 2017/18 Special Tax Roll

APN	Situs Address	Levy
118-441-020	107 CROW PL	271.82
118-441-021	109 CROW PL	271.82
118-441-022	111 CROW PL	271.82
118-441-023	113 CROW PL	271.82
118-441-024	115 CROW PL	271.82
118-441-025	117 CROW PL	271.82
118-441-026	119 CROW PL	271.82
118-442-001	118 CROW PL	271.82
118-442-002	116 CROW PL	271.82
118-442-003	114 CROW PL	271.82
118-442-004	112 CROW PL	271.82
118-442-005	110 CROW PL	271.82
118-442-006	108 CROW PL	271.82
118-442-007	106 CROW PL	271.82
118-442-008	104 CROW PL	271.82
118-442-009	102 CROW PL	271.82
118-442-010	3009 WINDMILL CANYON DR	271.82
118-442-011	3011 WINDMILL CANYON DR	271.82
118-442-012	3013 WINDMILL CANYON DR	271.82
118-442-013	3015 WINDMILL CANYON DR	271.82
118-442-014	3017 WINDMILL CANYON DR	271.82
118-442-015	3019 WINDMILL CANYON DR	271.82
118-442-016	3021 WINDMILL CANYON DR	271.82
118-442-017	3023 WINDMILL CANYON DR	271.82
118-443-001	3022 WINDMILL CANYON DR	271.82
118-443-002	3020 WINDMILL CANYON DR	271.82
118-443-003	3018 WINDMILL CANYON DR	271.82
118-443-004	3016 WINDMILL CANYON DR	271.82
118-443-005	3014 WINDMILL CANYON DR	271.82
118-443-006	3012 WINDMILL CANYON DR	271.82
118-443-007	3010 WINDMILL CANYON DR	271.82
118-451-001	301 WINDMILL CANYON PL	271.82
118-451-002	303 WINDMILL CANYON PL	271.82
118-451-003	305 WINDMILL CANYON PL	271.82
118-451-004	307 WINDMILL CANYON PL	271.82
118-451-005	309 WINDMILL CANYON PL	271.82
118-451-006	311 WINDMILL CANYON PL	271.82
118-451-007	313 WINDMILL CANYON PL	271.82
118-451-008	315 WINDMILL CANYON PL	271.82
118-451-009	317 WINDMILL CANYON PL	271.82



City of Clayton
Community Facilities District 1990-1R
Clayton Middle School
Fiscal Year 2017/18 Special Tax Roll

APN	Situs Address	Levy
118-451-010	319 WINDMILL CANYON PL	271.82
118-451-011	321 WINDMILL CANYON PL	271.82
118-452-001	322 WINDMILL CANYON PL	271.82
118-452-002	320 WINDMILL CANYON PL	271.82
118-452-003	318 WINDMILL CANYON PL	271.82
118-452-004	316 WINDMILL CANYON PL	271.82
118-452-005	314 WINDMILL CANYON PL	271.82
118-452-006	312 WINDMILL CANYON PL	271.82
118-452-007	310 WINDMILL CANYON PL	271.82
118-452-008	308 WINDMILL CANYON PL	271.82
118-452-009	306 WINDMILL CANYON PL	271.82
118-452-010	304 WINDMILL CANYON PL	271.82
118-452-011	302 WINDMILL CANYON PL	271.82
118-452-012	201 FALCON PL	271.82
118-452-013	203 FALCON PL	271.82
118-452-014	205 FALCON PL	271.82
118-452-015	207 FALCON PL	271.82
118-452-016	209 FALCON PL	271.82
118-452-017	211 FALCON PL	271.82
118-452-018	213 FALCON PL	271.82
118-452-019	215 FALCON PL	271.82
118-452-020	216 FALCON PL	271.82
118-452-021	214 FALCON PL	271.82
118-452-022	212 FALCON PL	271.82
118-452-023	210 FALCON PL	271.82
118-452-024	208 FALCON PL	271.82
118-452-025	206 FALCON PL	271.82
118-452-026	204 FALCON PL	271.82
118-452-027	202 FALCON PL	271.82
118-452-028	5126 KELLER RIDGE DR	271.82
118-452-029	5122 KELLER RIDGE DR	271.82
118-452-030	5120 KELLER RIDGE DR	271.82
118-452-031	5118 KELLER RIDGE DR	271.82
118-452-032	5116 KELLER RIDGE DR	271.82
118-452-033	5114 KELLER RIDGE DR	271.82
118-452-034	5112 KELLER RIDGE DR	271.82
118-452-035	5110 KELLER RIDGE DR	271.82
118-452-036	5108 KELLER RIDGE DR	271.82
118-452-037	5106 KELLER RIDGE DR	271.82
118-452-038	5102 KELLER RIDGE DR	271.82



City of Clayton
Community Facilities District 1990-1R
Clayton Middle School
Fiscal Year 2017/18 Special Tax Roll

APN	Situs Address	Levy
118-460-001	600 JLPUN LOOP	233.64
118-460-002	602 JLPUN LOOP	233.64
118-460-003	604 JLPUN LOOP	233.64
118-460-004	606 JLPUN LOOP	233.64
118-460-005	608 JLPUN LOOP	233.64
118-460-006	610 JLPUN LOOP	233.64
118-460-007	612 JLPUN LOOP	233.64
118-460-008	614 JLPUN LOOP	233.64
118-460-009	616 JLPUN LOOP	233.64
118-460-010	618 JLPUN LOOP	233.64
118-460-011	620 JLPUN LOOP	233.64
118-460-012	622 JLPUN LOOP	233.64
118-460-013	615 JLPUN LOOP	233.64
118-460-014	609 JLPUN LOOP	233.64
118-460-015	605 JLPUN LOOP	233.64
118-460-016	601 JLPUN LOOP	233.64
118-460-017	637 JLPUN LOOP	233.64
118-460-018	633 JLPUN LOOP	233.64
118-460-019	629 JLPUN LOOP	233.64
118-460-020	625 JLPUN LOOP	233.64
118-460-021	624 JLPUN LOOP	233.64
118-460-022	626 JLPUN LOOP	233.64
118-460-023	628 JLPUN LOOP	233.64
118-460-024	630 JLPUN LOOP	233.64
118-460-025	632 JLPUN LOOP	233.64
118-460-026	634 JLPUN LOOP	233.64
118-460-027	636 JLPUN LOOP	233.64
118-460-028	638 JLPUN LOOP	233.64
118-460-029	800 CHERT PL	233.64
118-460-030	802 CHERT PL	233.64
118-460-031	804 CHERT PL	233.64
118-460-032	806 CHERT PL	233.64
118-460-033	808 CHERT PL	233.64
118-460-034	810 CHERT PL	233.64
118-460-035	812 CHERT PL	233.64
118-460-036	814 CHERT PL	233.64
118-460-037	819 CHERT PL	233.64
118-460-038	817 CHERT PL	233.64
118-460-039	815 CHERT PL	233.64
118-460-040	813 CHERT PL	233.64



City of Clayton
Community Facilities District 1990-1R
Clayton Middle School
Fiscal Year 2017/18 Special Tax Roll

APN	Situs Address	Levy
118-460-041	811 CHERT PL	233.64
118-460-042	809 CHERT PL	233.64
118-460-043	807 CHERT PL	233.64
118-460-044	805 CHERT PL	233.64
118-460-045	803 CHERT PL	233.64
118-460-046	801 CHERT PL	233.64
118-460-047	51 KARKIN PL	233.64
118-460-048	53 KARKIN PL	233.64
118-460-049	55 KARKIN PL	233.64
118-460-050	57 KARKIN PL	233.64
118-460-051	56 KARKIN PL	233.64
118-460-052	54 KARKIN PL	233.64
118-460-053	52 KARKIN PL	233.64
118-460-054	1733 INDIAN WELLS WAY	233.64
118-460-055	501 SUISUN CT	233.64
118-460-056	503 SUISUN CT	233.64
118-460-057	505 SUISUN CT	233.64
118-460-058	507 SUISUN CT	233.64
118-460-059	509 SUISUN CT	233.64
118-460-060	511 SUISUN CT	233.64
118-460-061	510 SUISUN CT	233.64
118-460-062	508 SUISUN CT	233.64
118-460-063	506 SUISUN CT	233.64
118-460-064	504 SUISUN CT	233.64
118-460-065	502 SUISUN CT	233.64
118-460-066	1731 INDIAN WELLS WAY	233.64
118-460-067	1729 INDIAN WELLS WAY	233.64
118-460-068	1727 INDIAN WELLS WAY	233.64
118-460-069	1725 INDIAN WELLS WAY	233.64
118-460-070	1723 INDIAN WELLS WAY	233.64
118-460-071	1721 INDIAN WELLS WAY	233.64
118-460-072	1719 INDIAN WELLS WAY	233.64
118-460-073	722 ANIZUMNE CT	233.64
118-460-074	720 ANIZUMNE CT	233.64
118-460-075	718 ANIZUMNE CT	233.64
118-460-076	716 ANIZUMNE CT	233.64
118-460-077	714 ANIZUMNE CT	233.64
118-460-078	712 ANIZUMNE CT	233.64
118-460-079	710 ANIZUMNE CT	233.64
118-460-080	708 ANIZUMNE CT	233.64



City of Clayton
Community Facilities District 1990-1R
Clayton Middle School
Fiscal Year 2017/18 Special Tax Roll

APN	Situs Address	Levy
118-460-081	706 ANIZUMNE CT	233.64
118-460-082	704 ANIZUMNE CT	233.64
118-460-083	702 ANIZUMNE CT	233.64
118-460-084	700 ANIZUMNE CT	233.64
118-460-085	1717 INDIAN WELLS WAY	233.64
118-460-086	1715 INDIAN WELLS WAY	233.64
118-460-087	1713 INDIAN WELLS WAY	233.64
118-460-088	1711 INDIAN WELLS WAY	233.64
118-460-089	901 ARROWHEAD TER	233.64
118-460-090	903 ARROWHEAD TER	233.64
118-460-091	905 ARROWHEAD TER	233.64
118-460-092	907 ARROWHEAD TER	233.64
118-460-093	909 ARROWHEAD TER	233.64
118-460-094	911 ARROWHEAD TER	233.64
118-460-095	913 ARROWHEAD TER	233.64
118-460-096	915 ARROWHEAD TER	233.64
118-460-097	917 ARROWHEAD TER	233.64
118-460-098	919 ARROWHEAD TER	233.64
118-460-099	921 ARROWHEAD TER	233.64
118-460-100	923 ARROWHEAD TER	233.64
118-460-101	925 ARROWHEAD TER	233.64
118-460-102	927 ARROWHEAD TER	233.64
118-460-103	929 ARROWHEAD TER	233.64
118-460-105	926 ARROWHEAD TER	233.64
118-460-106	924 ARROWHEAD TER	233.64
118-460-107	922 ARROWHEAD TER	233.64
118-460-108	920 ARROWHEAD TER	233.64
118-460-109	918 ARROWHEAD TER	233.64
118-460-110	916 ARROWHEAD TER	233.64
118-460-111	914 ARROWHEAD TER	233.64
118-460-112	912 ARROWHEAD CIR	233.64
118-460-113	910 ARROWHEAD TER	233.64
118-460-114	908 ARROWHEAD TER	233.64
118-460-115	906 ARROWHEAD TER	233.64
118-460-116	904 ARROWHEAD TER	233.64
118-460-117	902 ARROWHEAD TER	233.64
118-460-118	900 ARROWHEAD TER	233.64
118-460-121	931 ARROWHEAD TER	233.64
118-470-003	1207 BUCKEYE TER	233.64
118-470-004	1205 BUCKEYE TER	233.64



City of Clayton
Community Facilities District 1990-1R
Clayton Middle School
Fiscal Year 2017/18 Special Tax Roll

APN	Situs Address	Levy
118-470-005	1203 BUCKEYE TER	233.64
118-470-006	1201 BUCKEYE TER	233.64
118-470-007	1211 BUCKEYE TER	233.64
118-470-008	1209 BUCKEYE TER	233.64
118-470-009	1213 BUCKEYE TER	233.64
118-470-010	1215 BUCKEYE TER	233.64
118-470-011	1217 BUCKEYE TER	233.64
118-470-012	1221 BUCKEYE TER	233.64
118-470-013	1223 BUCKEYE TER	233.64
118-470-014	1225 BUCKEYE TER	233.64
118-470-015	1227 BUCKEYE TER	233.64
118-470-016	1231 BUCKEYE TER	233.64
118-470-017	1233 BUCKEYE TER	233.64
118-470-018	1235 BUCKEYE TER	233.64
118-470-019	1237 BUCKEYE TER	233.64
118-470-020	1239 BUCKEYE TER	233.64
118-470-021	1241 BUCKEYE TER	233.64
118-470-022	1240 BUCKEYE TER	233.64
118-470-023	1238 BUCKEYE TER	233.64
118-470-024	1236 BUCKEYE TER	233.64
118-470-025	1234 BUCKEYE TER	233.64
118-470-026	1232 BUCKEYE TER	233.64
118-470-027	1230 BUCKEYE TER	233.64
118-470-028	1228 BUCKEYE TER	233.64
118-470-029	1226 BUCKEYE TER	233.64
118-470-030	1220 BUCKEYE TER	233.64
118-470-031	1218 BUCKEYE TER	233.64
118-470-032	1216 BUCKEYE TER	233.64
118-470-033	1214 BUCKEYE TER	233.64
118-470-034	1212 BUCKEYE TER	233.64
118-470-035	1200 BUCKEYE TER	233.64
118-470-036	1151 MOCCASIN CT	233.64
118-470-037	1153 MOCCASIN CT	233.64
118-470-038	1155 MOCCASIN CT	233.64
118-470-039	1159 MOCCASIN CT	233.64
118-470-040	1161 MOCCASIN CT	233.64
118-470-041	1163 MOCCASIN CT	233.64
118-470-042	1165 MOCCASIN CT	233.64
118-470-043	1169 MOCCASIN CT	233.64
118-470-044	1171 MOCCASIN CT	233.64



City of Clayton
Community Facilities District 1990-1R
Clayton Middle School
Fiscal Year 2017/18 Special Tax Roll

APN	Situs Address	Levy
118-470-045	1173 MOCCASIN CT	233.64
118-470-046	1175 MOCCASIN CT	233.64
118-470-047	1174 MOCCASIN CT	233.64
118-470-048	1172 MOCCASIN CT	233.64
118-470-049	1170 MOCCASIN CT	233.64
118-470-050	1168 MOCCASIN CT	233.64
118-470-051	1166 MOCCASIN CT	233.64
118-470-052	1164 MOCCASIN CT	233.64
118-470-053	1160 MOCCASIN CT	233.64
118-470-054	1158 MOCCASIN CT	233.64
118-470-055	1156 MOCCASIN CT	233.64
118-470-056	1154 MOCCASIN CT	233.64
118-470-057	1152 MOCCASIN CT	233.64
118-470-063	1001 FEATHER CIR	233.64
118-470-064	1003 FEATHER CIR	233.64
118-470-065	1005 FEATHER CIR	233.64
118-470-066	1007 FEATHER CIR	233.64
118-470-067	1009 FEATHER CIR	233.64
118-470-068	1011 FEATHER CIR	233.64
118-470-069	1015 FEATHER CIR	233.64
118-470-070	1017 FEATHER CIR	233.64
118-470-071	1019 FEATHER CIR	233.64
118-470-072	1021 FEATHER CIR	233.64
118-470-076	1029 FEATHER CIR	233.64
118-470-079	1035 FEATHER CIR	233.64
118-470-080	1037 FEATHER CIR	233.64
118-470-081	1039 FEATHER CIR	233.64
118-470-082	1041 FEATHER CIR	233.64
118-470-083	1043 FEATHER CIR	233.64
118-470-084	1045 FEATHER CIR	233.64
118-470-085	1047 FEATHER CIR	233.64
118-470-086	1049 FEATHER CIR	233.64
118-470-087	1051 FEATHER CIR	233.64
118-470-088	1053 FEATHER CIR	233.64
118-470-089	1055 FEATHER CIR	233.64
118-470-090	1059 FEATHER CIR	233.64
118-470-091	1061 FEATHER CIR	233.64
118-470-092	1063 FEATHER CIR	233.64
118-470-093	1065 FEATHER CIR	233.64
118-470-094	1067 FEATHER CIR	233.64



City of Clayton
Community Facilities District 1990-1R
Clayton Middle School
Fiscal Year 2017/18 Special Tax Roll

APN	Situs Address	Levy
118-470-095	1069 FEATHER CIR	233.64
118-470-096	1071 FEATHER CIR	233.64
118-470-097	1073 FEATHER CIR	233.64
118-470-098	1075 FEATHER CIR	233.64
118-470-099	1077 FEATHER CIR	233.64
118-470-100	1079 FEATHER CIR	233.64
118-470-101	1074 FEATHER CIR	233.64
118-470-102	1072 FEATHER CIR	233.64
118-470-103	1070 FEATHER CIR	233.64
118-470-104	1066 FEATHER CIR	233.64
118-470-105	1054 FEATHER CIR	233.64
118-470-106	1052 FEATHER CIR	233.64
118-470-107	1050 FEATHER CIR	233.64
118-470-108	1048 FEATHER CIR	233.64
118-470-109	1038 FEATHER CIR	233.64
118-470-110	1034 FEATHER CIR	233.64
118-470-111	1032 FEATHER CIR	233.64
118-470-112	1028 FEATHER CIR	233.64
118-470-113	1016 FEATHER CIR	233.64
118-470-114	1014 FEATHER CIR	233.64
118-470-115	1012 FEATHER CIR	233.64
118-470-118	1023 FEATHER CIR	233.64
118-470-119	1025 FEATHER CIR	233.64
118-470-120	1027 FEATHER CIR	233.64
118-470-121	1031 FEATHER CIR	233.64
118-470-122	1033 FEATHER CIR	233.64
118-480-001	100 FOREST HILL DR	472.68
118-480-002	102 FOREST HILL DR	472.68
118-480-003	104 FOREST HILL DR	472.68
118-480-004	106 FOREST HILL DR	472.68
118-480-005	108 FOREST HILL DR	472.68
118-480-006	110 FOREST HILL DR	472.68
118-480-007	112 FOREST HILL DR	472.68
118-480-008	114 FOREST HILL DR	472.68
118-480-009	116 FOREST HILL DR	472.68
118-480-010	118 FOREST HILL DR	472.68
118-480-011	120 FOREST HILL DR	472.68
118-480-012	121 FOREST HILL DR	472.68
118-480-013	119 FOREST HILL DR	472.68
118-480-014	117 FOREST HILL DR	472.68



City of Clayton
Community Facilities District 1990-1R
Clayton Middle School
Fiscal Year 2017/18 Special Tax Roll

APN	Situs Address	Levy
118-480-015	115 FOREST HILL DR	472.68
118-480-016	113 FOREST HILL DR	472.68
118-480-017	111 FOREST HILL DR	472.68
118-480-018	109 FOREST HILL DR	472.68
118-480-019	105 FOREST HILL DR	472.68
118-480-020	103 FOREST HILL DR	472.68
118-480-023	1008 PEBBLE BEACH DR	472.68
118-480-024	1010 PEBBLE BEACH DR	472.68
118-480-025	1012 PEBBLE BEACH DR	472.68
118-480-026	1014 PEBBLE BEACH DR	472.68
118-480-027	1016 PEBBLE BEACH DR	472.68
118-480-028	1018 PEBBLE BEACH DR	472.68
118-480-029	1020 PEBBLE BEACH DR	472.68
118-480-030	1022 PEBBLE BEACH DR	472.68
118-480-031	1024 PEBBLE BEACH DR	472.68
118-480-034	1033 PEBBLE BEACH DR	472.68
118-480-035	1031 PEBBLE BEACH DR	472.68
118-480-036	1029 PEBBLE BEACH DR	472.68
118-480-037	1027 PEBBLE BEACH DR	472.68
118-480-038	1025 PEBBLE BEACH DR	472.68
118-480-039	1023 PEBBLE BEACH DR	472.68
118-480-040	1021 PEBBLE BEACH DR	472.68
118-480-041	1011 PEBBLE BEACH DR	472.68
118-480-042	1009 PEBBLE BEACH DR	472.68
118-480-043	1007 PEBBLE BEACH DR	472.68
118-480-044	1005 PEBBLE BEACH DR	472.68
118-480-045	1003 PEBBLE BEACH DR	472.68
118-480-046	101 FOREST HILL DR	472.68
118-480-047	1006 PEBBLE BEACH DR	472.68
118-480-048	1028 PEBBLE BEACH DR	945.36
118-490-001	132 INVERNESS WAY	472.68
118-490-003	138 INVERNESS WAY	472.68
118-490-005	140 INVERNESS WAY	472.68
118-490-006	142 INVERNESS WAY	472.68
118-490-007	1032 PEBBLE BEACH DR	472.68
118-490-008	1034 PEBBLE BEACH DR	472.68
118-490-009	1036 PEBBLE BEACH DR	472.68
118-490-010	1038 PEBBLE BEACH DR	472.68
118-490-011	1040 PEBBLE BEACH DR	472.68
118-490-012	1042 PEBBLE BEACH DR	472.68



City of Clayton
Community Facilities District 1990-1R
Clayton Middle School
Fiscal Year 2017/18 Special Tax Roll

APN	Situs Address	Levy
118-490-013	1044 PEBBLE BEACH DR	472.68
118-490-014	1046 PEBBLE BEACH DR	472.68
118-490-015	1048 PEBBLE BEACH DR	472.68
118-490-016	1050 PEBBLE BEACH DR	472.68
118-490-017	1052 PEBBLE BEACH DR	472.68
118-490-018	1054 PEBBLE BEACH DR	472.68
118-490-019	1056 PEBBLE BEACH DR	472.68
118-490-020	1055 PEBBLE BEACH DR	472.68
118-490-021	1053 PEBBLE BEACH DR	472.68
118-490-022	1051 PEBBLE BEACH DR	472.68
118-490-023	1049 PEBBLE BEACH DR	472.68
118-490-024	1047 PEBBLE BEACH DR	472.68
118-490-025	1045 PEBBLE BEACH DR	472.68
118-490-027	134 INVERNESS WAY	472.68
118-490-028	136 INVERNESS WAY	472.68
118-500-001	1100 PEACOCK CREEK DR	472.68
118-500-002	1102 PEACOCK CREEK DR	472.68
118-500-005	1108 PEACOCK CREEK DR	472.68
118-500-006	1110 PEACOCK CREEK DR	472.68
118-500-007	1112 PEACOCK CREEK DR	472.68
118-500-008	1114 PEACOCK CREEK DR	472.68
118-500-009	1116 PEACOCK CREEK DR	472.68
118-500-010	1118 PEACOCK CREEK DR	472.68
118-500-011	1120 PEACOCK CREEK DR	472.68
118-500-012	1122 PEACOCK CREEK DR	472.68
118-500-013	1124 PEACOCK CREEK DR	472.68
118-500-014	1126 PEACOCK CREEK DR	472.68
118-500-015	1128 PEACOCK CREEK DR	472.68
118-500-016	1130 PEACOCK CREEK DR	472.68
118-500-017	1132 PEACOCK CREEK DR	472.68
118-500-018	1133 PEACOCK CREEK DR	472.68
118-500-019	1131 PEACOCK CREEK DR	472.68
118-500-020	1129 PEACOCK CREEK DR	472.68
118-500-021	1127 PEACOCK CREEK DR	472.68
118-500-022	1125 PEACOCK CREEK DR	472.68
118-500-023	1123 PEACOCK CREEK DR	472.68
118-500-024	1121 PEACOCK CREEK DR	472.68
118-500-025	1117 PEACOCK CREEK DR	472.68
118-500-026	1115 PEACOCK CREEK DR	472.68
118-500-027	1111 PEACOCK CREEK DR	472.68



City of Clayton
Community Facilities District 1990-1R
Clayton Middle School
Fiscal Year 2017/18 Special Tax Roll

APN	Situation Address	Levy
118-500-028	1109 PEACOCK CREEK DR	472.68
118-500-029	1107 PEACOCK CREEK DR	472.68
118-500-030	1105 PEACOCK CREEK DR	472.68
118-500-031	1103 PEACOCK CREEK DR	472.68
118-500-032	1104 PEACOCK CREEK DR	472.68
118-500-033	1106 PEACOCK CREEK DR	472.68
118-510-001	1134 PEACOCK CREEK DR	472.68
118-510-002	1136 PEACOCK CREEK DR	472.68
118-510-003	1138 PEACOCK CREEK DR	472.68
118-510-004	1140 PEACOCK CREEK DR	472.68
118-510-005	1142 PEACOCK CREEK DR	472.68
118-510-006	1144 PEACOCK CREEK DR	472.68
118-510-007	1146 PEACOCK CREEK DR	472.68
118-510-008	1148 PEACOCK CREEK DR	472.68
118-510-009	1150 PEACOCK CREEK DR	472.68
118-510-010	1152 PEACOCK CREEK DR	472.68
118-510-011	170 BRANDYWINE PL	472.68
118-510-012	172 BRANDYWINE PL	472.68
118-510-013	174 BRANDYWINE PL	472.68
118-510-015	185 BRANDYWINE PL	472.68
118-510-016	183 BRANDYWINE PL	472.68
118-510-017	181 BRANDYWINE PL	472.68
118-510-018	179 BRANDYWINE PL	472.68
118-510-019	177 BRANDYWINE PL	472.68
118-510-020	175 BRANDYWINE PL	472.68
118-510-021	173 BRANDYWINE PL	472.68
118-510-022	1160 TORREY PINES PL	472.68
118-510-023	1162 TORREY PINES PL	472.68
118-510-024	1163 TORREY PINES PL	472.68
118-510-025	1161 TORREY PINES PL	472.68
118-510-026	1155 PEACOCK CREEK DR	472.68
118-510-027	1151 PEACOCK CREEK DR	472.68
118-510-028	164 SILVERADO CT	472.68
118-510-029	166 SILVERADO CT	472.68
118-510-030	165 SILVERADO CT	472.68
118-510-031	163 SILVERADO CT	472.68
118-510-032	1149 PEACOCK CREEK DR	472.68
118-510-033	1147 PEACOCK CREEK DR	472.68
118-510-034	1145 PEACOCK CREEK DR	472.68
118-510-035	154 LONE PINE CT	472.68



City of Clayton
Community Facilities District 1990-1R
Clayton Middle School
Fiscal Year 2017/18 Special Tax Roll

APN	Situs Address	Levy
118-510-036	156 LONE PINE CT	472.68
118-510-037	155 LONE PINE CT	472.68
118-510-038	153 LONE PINE CT	472.68
118-510-039	151 LONE PINE CT	472.68
118-510-040	1139 PEACOCK CREEK DR	472.68
118-510-041	1137 PEACOCK CREEK DR	472.68
118-510-042	1135 PEACOCK CREEK DR	472.68
118-530-001	1401 INDIANHEAD WAY	189.70
118-530-002	1403 INDIANHEAD WAY	189.70
118-530-003	1405 INDIANHEAD WAY	189.70
118-530-004	1407 INDIANHEAD WAY	189.70
118-530-005	1409 INDIANHEAD WAY	189.70
118-530-006	1411 INDIANHEAD WAY	189.70
118-530-007	1413 INDIANHEAD WAY	189.70
118-530-008	1415 INDIANHEAD WAY	189.70
118-530-009	1417 INDIANHEAD WAY	189.70
118-530-010	1419 INDIANHEAD WAY	189.70
118-530-011	1421 INDIANHEAD WAY	189.70
118-530-012	1423 INDIANHEAD WAY	189.70
118-530-013	1425 INDIANHEAD WAY	189.70
118-530-014	1427 INDIANHEAD WAY	189.70
118-530-015	1429 INDIANHEAD WAY	189.70
118-530-016	1431 INDIANHEAD WAY	189.70
118-530-017	1433 INDIANHEAD CIR	189.70
118-530-018	1435 INDIANHEAD CIR	189.70
118-530-019	1437 INDIANHEAD CIR	189.70
118-530-020	1439 INDIANHEAD CIR	189.70
118-530-021	1441 INDIANHEAD CIR	189.70
118-530-022	1443 INDIANHEAD CIR	189.70
118-530-023	1445 INDIANHEAD CIR	189.70
118-530-024	1447 INDIANHEAD CIR	189.70
118-530-025	1449 INDIANHEAD CIR	189.70
118-530-026	1451 INDIANHEAD CIR	189.70
118-530-027	1453 INDIANHEAD CIR	189.70
118-530-028	1455 INDIANHEAD CIR	189.70
118-530-029	1457 INDIANHEAD CIR	189.70
118-530-030	1459 INDIANHEAD CIR	189.70
118-530-031	1461 INDIANHEAD CIR	189.70
118-530-033	1465 INDIANHEAD CIR	189.70
118-530-034	1467 INDIANHEAD CIR	189.70



City of Clayton
Community Facilities District 1990-1R
Clayton Middle School
Fiscal Year 2017/18 Special Tax Roll

APN	Situs Address	Levy
118-530-035	1469 INDIANHEAD CIR	189.70
118-530-036	1471 INDIANHEAD CIR	189.70
118-530-037	1473 INDIANHEAD CIR	189.70
118-530-038	1475 INDIANHEAD CIR	189.70
118-530-039	1477 INDIANHEAD CIR	189.70
118-530-040	1479 INDIANHEAD CIR	189.70
118-530-041	1481 INDIANHEAD CIR	189.70
118-530-042	1483 INDIANHEAD CIR	189.70
118-530-043	1485 INDIANHEAD CIR	189.70
118-530-044	1487 INDIANHEAD CIR	189.70
118-530-045	1489 INDIANHEAD CIR	189.70
118-530-046	1491 INDIANHEAD CIR	189.70
118-530-047	1466 INDIANHEAD CIR	189.70
118-530-048	1464 INDIANHEAD CIR	189.70
118-530-049	1462 INDIANHEAD CIR	189.70
118-530-050	1460 INDIANHEAD CIR	189.70
118-530-051	1458 INDIANHEAD CIR	189.70
118-530-052	1456 INDIANHEAD CIR	189.70
118-530-056	1463 INDIANHEAD CIR	189.70
118-540-001	4001 HUMMINGBIRD WAY	271.82
118-540-002	4003 HUMMINGBIRD WAY	271.82
118-540-003	4005 HUMMINGBIRD WAY	271.82
118-540-004	4007 HUMMINGBIRD WAY	271.82
118-540-005	4009 HUMMINGBIRD WAY	271.82
118-540-006	4011 HUMMINGBIRD WAY	271.82
118-540-007	4013 HUMMINGBIRD WAY	271.82
118-540-008	4015 HUMMINGBIRD WAY	271.82
118-540-009	4017 HUMMINGBIRD WAY	271.82
118-540-010	4019 HUMMINGBIRD WAY	271.82
118-540-011	4021 HUMMINGBIRD WAY	271.82
118-540-012	4022 HUMMINGBIRD WAY	271.82
118-540-013	4018 HUMMINGBIRD WAY	271.82
118-540-014	4014 HUMMINGBIRD WAY	271.82
118-540-015	4010 HUMMINGBIRD WAY	271.82
118-540-016	4008 HUMMINGBIRD WAY	271.82
118-540-017	4006 HUMMINGBIRD WAY	271.82
118-540-018	4004 HUMMINGBIRD WAY	271.82
118-540-019	4002 HUMMINGBIRD WAY	271.82
118-540-020	5001 RAVEN WAY	271.82
118-540-021	5003 RAVEN WAY	271.82



City of Clayton
Community Facilities District 1990-1R
Clayton Middle School
Fiscal Year 2017/18 Special Tax Roll

APN	Situs Address	Levy
118-540-022	5005 RAVEN WAY	271.82
118-540-023	5007 RAVEN WAY	271.82
118-540-024	5009 RAVEN WAY	271.82
118-540-025	5011 RAVEN WAY	271.82
118-540-026	4024 HUMMINGBIRD WAY	271.82
118-540-027	5013 RAVEN WAY	271.82
118-540-028	5015 RAVEN WAY	271.82
118-540-029	5017 RAVEN WAY	271.82
118-540-030	5019 RAVEN WAY	271.82
118-540-031	3038 WINDMILL CANYON DR	271.82
118-540-032	3036 WINDMILL CANYON DR	271.82
118-540-033	3034 WINDMILL CANYON DR	271.82
118-540-034	3032 WINDMILL CANYON DR	271.82
118-540-035	3030 WINDMILL CANYON DR	271.82
118-540-036	3028 WINDMILL CANYON DR	271.82
118-540-037	3026 WINDMILL CANYON DR	271.82
118-540-038	3024 WINDMILL CANYON DR	271.82
118-540-039	3025 WINDMILL CANYON DR	271.82
118-540-040	3027 WINDMILL CANYON DR	271.82
118-540-041	3029 WINDMILL CANYON DR	271.82
118-540-042	3031 WINDMILL CANYON DR	271.82
118-540-043	3033 WINDMILL CANYON DR	271.82
118-540-044	3035 WINDMILL CANYON DR	271.82
118-540-045	3037 WINDMILL CANYON DR	271.82
118-540-046	3039 WINDMILL CANYON DR	271.82
118-540-047	3041 WINDMILL CANYON DR	271.82
118-540-048	3043 WINDMILL CANYON DR	271.82
118-540-049	3045 WINDMILL CANYON DR	271.82
118-540-050	3047 WINDMILL CANYON DR	271.82
118-540-051	3049 WINDMILL CANYON DR	271.82
118-540-052	3051 WINDMILL CANYON DR	271.82
118-540-053	3053 WINDMILL CANYON DR	271.82
118-540-054	5022 RAVEN WAY	271.82
118-540-055	5020 RAVEN WAY	271.82
118-540-056	5018 RAVEN WAY	271.82
118-540-057	5016 RAVEN WAY	271.82
118-540-058	5014 RAVEN WAY	271.82
118-540-059	5012 RAVEN WAY	271.82
118-540-060	5010 RAVEN WAY	271.82
118-540-061	5008 RAVEN WAY	271.82



City of Clayton
Community Facilities District 1990-1R
Clayton Middle School
Fiscal Year 2017/18 Special Tax Roll

APN	Situs Address	Levy
118-540-062	5006 RAVEN WAY	271.82
118-540-063	5004 RAVEN WAY	271.82
118-540-064	5002 RAVEN WAY	271.82
118-540-065	5000 RAVEN WAY	271.82
118-550-002	610 GOLDEN EAGLE PL	271.82
118-550-003	608 GOLDEN EAGLE PL	271.82
118-550-004	606 GOLDEN EAGLE PL	271.82
118-550-005	604 GOLDEN EAGLE PL	271.82
118-550-006	602 GOLDEN EAGLE PL	271.82
118-550-007	501 RAVEN PL	271.82
118-550-008	503 RAVEN PL	271.82
118-550-009	505 RAVEN PL	271.82
118-550-010	507 RAVEN PL	271.82
118-550-011	509 RAVEN PL	271.82
118-550-012	511 RAVEN PL	271.82
118-550-013	513 RAVEN PL	271.82
118-550-014	514 RAVEN PL	271.82
118-550-015	512 RAVEN PL	271.82
118-550-016	510 RAVEN PL	271.82
118-550-017	508 RAVEN PL	271.82
118-550-018	506 RAVEN PL	271.82
118-550-019	504 RAVEN PL	271.82
118-550-020	502 RAVEN PL	271.82
118-550-021	401 HUMMINGBIRD PL	271.82
118-550-022	403 HUMMINGBIRD PL	271.82
118-550-023	405 HUMMINGBIRD PL	271.82
118-550-024	407 HUMMINGBIRD PL	271.82
118-550-025	409 HUMMINGBIRD PL	271.82
118-550-026	411 HUMMINGBIRD PL	271.82
118-550-027	413 HUMMINGBIRD PL	271.82
118-550-028	418 HUMMINGBIRD PL	271.82
118-550-029	416 HUMMINGBIRD PL	271.82
118-550-030	414 HUMMINGBIRD PL	271.82
118-550-031	412 HUMMINGBIRD PL	271.82
118-550-032	410 HUMMINGBIRD PL	271.82
118-550-033	408 HUMMINGBIRD PL	271.82
118-550-034	406 HUMMINGBIRD PL	271.82
118-550-035	404 HUMMINGBIRD PL	271.82
118-550-036	402 HUMMINGBIRD PL	271.82
118-550-038	612 GOLDEN EAGLE PL	271.82



City of Clayton
Community Facilities District 1990-1R
Clayton Middle School
Fiscal Year 2017/18 Special Tax Roll

APN	Situs Address	Levy
118-570-001	363 BLUE OAK LN	406.16
118-570-002	365 BLUE OAK LN	406.16
118-570-003	367 BLUE OAK LN	406.16
118-570-004	369 BLUE OAK LN	406.16
118-570-005	371 BLUE OAK LN	406.16
118-570-006	373 BLUE OAK LN	406.16
118-570-007	375 BLUE OAK LN	406.16
118-570-008	377 BLUE OAK LN	406.16
118-570-009	379 BLUE OAK LN	406.16
118-570-010	381 BLUE OAK LN	406.16
118-570-012	385 BLUE OAK LN	406.16
118-570-013	387 BLUE OAK LN	406.16
118-570-014	389 BLUE OAK LN	406.16
118-570-015	391 BLUE OAK LN	406.16
118-570-016	390 BLUE OAK LN	406.16
118-570-017	388 BLUE OAK LN	406.16
118-570-018	81 WILDCAT WAY	406.16
118-570-019	83 WILDCAT WAY	406.16
118-570-020	85 WILDCAT WAY	406.16
118-570-021	477 OBSIDIAN WAY	406.16
118-570-022	479 OBSIDIAN WAY	406.16
118-570-023	478 OBSIDIAN WAY	406.16
118-570-024	476 OBSIDIAN WAY	406.16
118-570-025	474 OBSIDIAN WAY	406.16
118-570-026	470 OBSIDIAN WAY	406.16
118-570-027	468 OBSIDIAN WAY	406.16
118-570-028	63 ANTELOPE CT	406.16
118-570-029	65 ANTELOPE CT	406.16
118-570-030	66 ANTELOPE CT	406.16
118-570-031	64 ANTELOPE CT	406.16
118-570-032	62 ANTELOPE CT	406.16
118-570-033	60 ANTELOPE CT	406.16
118-570-034	458 OBSIDIAN WAY	406.16
118-570-035	456 OBSIDIAN WAY	406.16
118-570-038	56 TUYSHTAK CT	406.16
118-570-039	54 TUYSHTAK CT	406.16
118-570-040	52 TUYSHTAK CT	406.16
118-570-041	453 OBSIDIAN WAY	406.16
118-570-042	455 OBSIDIAN WAY	406.16
118-570-043	457 OBSIDIAN WAY	406.16



City of Clayton
Community Facilities District 1990-1R
Clayton Middle School
Fiscal Year 2017/18 Special Tax Roll

APN	Situation Address	Levy
118-570-044	459 OBSIDIAN WAY	406.16
118-570-045	461 OBSIDIAN WAY	406.16
118-570-046	463 OBSIDIAN WAY	406.16
118-570-047	465 OBSIDIAN WAY	406.16
118-570-048	467 OBSIDIAN WAY	406.16
118-570-049	469 OBSIDIAN WAY	406.16
118-570-050	471 OBSIDIAN WAY	406.16
118-570-051	473 OBSIDIAN WAY	406.16
118-570-052	84 WILDCAT WAY	406.16
118-570-053	380 BLUE OAK LN	406.16
118-570-054	376 BLUE OAK LN	406.16
118-570-055	374 BLUE OAK LN	406.16
118-570-056	372 BLUE OAK LN	406.16
118-570-057	370 BLUE OAK LN	406.16
118-570-058	368 BLUE OAK LN	406.16
118-570-059	366 BLUE OAK LN	406.16
118-570-060	362 BLUE OAK LN	406.16
118-570-061	383 BLUE OAK LN	406.16
118-570-062	53 TUYSHTAK CT	406.16
118-570-063	55 TUYSHTAK CT	406.16
118-580-001	200 CONDOR WAY	233.64
118-580-002	202 CONDOR WAY	233.64
118-580-003	204 CONDOR WAY	233.64
118-580-004	206 CONDOR WAY	233.64
118-580-005	208 CONDOR WAY	233.64
118-580-006	210 CONDOR WAY	233.64
118-580-007	212 CONDOR WAY	233.64
118-580-008	214 CONDOR WAY	233.64
118-580-009	216 CONDOR WAY	233.64
118-580-010	218 CONDOR WAY	233.64
118-580-011	220 CONDOR WAY	233.64
118-580-012	222 CONDOR WAY	233.64
118-580-013	224 CONDOR WAY	233.64
118-580-014	226 CONDOR WAY	233.64
118-580-015	5000 KELLER RIDGE DR	233.64
118-580-016	5002 KELLER RIDGE DR	233.64
118-580-017	5004 KELLER RIDGE DR	233.64
118-580-018	5006 KELLER RIDGE DR	233.64
118-580-019	5008 KELLER RIDGE DR	233.64
118-580-020	5010 KELLER RIDGE DR	233.64



City of Clayton
Community Facilities District 1990-1R
Clayton Middle School
Fiscal Year 2017/18 Special Tax Roll

APN	Situs Address	Levy
118-580-021	5012 KELLER RIDGE DR	233.64
118-580-022	5037 KELLER RIDGE DR	233.64
118-580-023	5035 KELLER RIDGE DR	233.64
118-580-024	5033 KELLER RIDGE DR	233.64
118-580-025	5031 KELLER RIDGE DR	233.64
118-580-026	5029 KELLER RIDGE DR	233.64
118-580-027	5027 KELLER RIDGE DR	233.64
118-580-028	5025 KELLER RIDGE DR	233.64
118-580-029	5023 KELLER RIDGE DR	233.64
118-580-030	5021 KELLER RIDGE DR	233.64
118-580-031	5019 KELLER RIDGE DR	233.64
118-580-032	5017 KELLER RIDGE DR	233.64
118-580-033	5015 KELLER RIDGE DR	233.64
118-580-034	5013 KELLER RIDGE DR	233.64
118-580-035	5011 KELLER RIDGE DR	233.64
118-590-004	4705 KELLER RIDGE DR	189.70
118-590-005	4707 KELLER RIDGE DR	189.70
118-590-006	4703 KELLER RIDGE DR	189.70
118-590-007	4701 KELLER RIDGE DR	189.70
118-590-009	4605 KELLER RIDGE DR	189.70
118-590-010	4607 KELLER RIDGE DR	189.70
118-590-011	4603 KELLER RIDGE DR	189.70
118-590-012	4601 KELLER RIDGE DR	189.70
118-590-015	4507 KELLER RIDGE DR	189.70
118-590-016	4505 KELLER RIDGE DR	189.70
118-590-017	4501 KELLER RIDGE DR	189.70
118-590-018	4503 KELLER RIDGE DR	189.70
118-590-022	4905 KELLER RIDGE DR	189.70
118-590-023	4907 KELLER RIDGE DR	189.70
118-590-024	4903 KELLER RIDGE DR	189.70
118-590-025	4901 KELLER RIDGE DR	189.70
118-590-027	4805 KELLER RIDGE DR	189.70
118-590-028	4807 KELLER RIDGE DR	189.70
118-590-029	4803 KELLER RIDGE DR	189.70
118-590-030	4801 KELLER RIDGE DR	189.70
118-600-001	905 CONDOR PL	189.70
118-600-002	907 CONDOR PL	189.70
118-600-003	903 CONDOR PL	189.70
118-600-004	901 CONDOR PL	189.70
118-600-006	807 CONDOR PL	189.70



City of Clayton
Community Facilities District 1990-1R
Clayton Middle School
Fiscal Year 2017/18 Special Tax Roll

APN	Situs Address	Levy
118-600-007	805 CONDOR PL	189.70
118-600-008	801 CONDOR PL	189.70
118-600-009	803 CONDOR PL	189.70
118-600-011	705 CONDOR PL	189.70
118-600-012	707 CONDOR PL	189.70
118-600-013	703 CONDOR PL	189.70
118-600-014	701 CONDOR PL	189.70
118-600-016	607 CONDOR PL	189.70
118-600-017	605 CONDOR PL	189.70
118-600-018	601 CONDOR PL	189.70
118-600-019	603 CONDOR PL	189.70
118-600-021	505 CONDOR PL	189.70
118-600-022	507 CONDOR PL	189.70
118-600-023	503 CONDOR PL	189.70
118-600-024	501 CONDOR PL	189.70
118-600-026	405 CONDOR PL	189.70
118-600-027	407 CONDOR PL	189.70
118-600-028	403 CONDOR PL	189.70
118-600-029	401 CONDOR PL	189.70
118-600-031	307 CONDOR PL	189.70
118-600-032	305 CONDOR PL	189.70
118-600-033	301 CONDOR PL	189.70
118-600-034	303 CONDOR PL	189.70
118-600-036	207 CONDOR PL	189.70
118-600-037	205 CONDOR PL	189.70
118-600-038	201 CONDOR PL	189.70
118-600-039	203 CONDOR PL	189.70
118-610-001	1947 EAGLE PEAK AVE	189.70
118-610-002	1945 EAGLE PEAK AVE	189.70
118-610-003	1941 EAGLE PEAK AVE	189.70
118-610-004	1943 EAGLE PEAK AVE	189.70
118-610-006	1925 EAGLE PEAK AVE	189.70
118-610-007	1927 EAGLE PEAK AVE	189.70
118-610-008	1923 EAGLE PEAK AVE	189.70
118-610-009	1921 EAGLE PEAK AVE	189.70
118-610-012	3905 COYOTE CIR	189.70
118-610-013	3907 COYOTE CIR	189.70
118-610-014	3903 COYOTE CIR	189.70
118-610-015	3901 COYOTE CIR	189.70
118-610-020	3805 COYOTE CIR	189.70



City of Clayton
Community Facilities District 1990-1R
Clayton Middle School
Fiscal Year 2017/18 Special Tax Roll

APN	Situs Address	Levy
118-610-021	3807 COYOTE CIR	189.70
118-610-022	3803 COYOTE CIR	189.70
118-610-023	3801 COYOTE CIR	189.70
118-610-024	3707 COYOTE CIR	189.70
118-610-025	3705 COYOTE CIR	189.70
118-610-026	3701 COYOTE CIR	189.70
118-610-027	3703 COYOTE CIR	189.70
118-610-028	3605 COYOTE CIR	189.70
118-610-029	3607 COYOTE CIR	189.70
118-610-030	3603 COYOTE CIR	189.70
118-610-031	3601 COYOTE CIR	189.70
118-620-001	6001 GOLDEN EAGLE WAY	271.82
118-620-002	6003 GOLDEN EAGLE WAY	271.82
118-620-003	6005 GOLDEN EAGLE WAY	271.82
118-620-004	6007 GOLDEN EAGLE WAY	271.82
118-620-005	6009 GOLDEN EAGLE WAY	271.82
118-620-006	6011 GOLDEN EAGLE WAY	271.82
118-620-007	6013 GOLDEN EAGLE WAY	271.82
118-620-008	3089 WINDMILL CANYON DR	271.82
118-620-009	3091 WINDMILL CANYON DR	271.82
118-620-010	3093 WINDMILL CANYON DR	271.82
118-620-011	3095 WINDMILL CANYON DR	271.82
118-620-012	3097 WINDMILL CANYON DR	271.82
118-620-013	3099 WINDMILL CANYON DR	271.82
118-620-014	3101 WINDMILL CANYON DR	271.82
118-620-015	3103 WINDMILL CANYON DR	271.82
118-620-016	3105 WINDMILL CANYON DR	271.82
118-620-017	3107 WINDMILL CANYON DR	271.82
118-620-018	3109 WINDMILL CANYON DR	271.82
118-620-019	3111 WINDMILL CANYON DR	271.82
118-620-020	6036 GOLDEN EAGLE WAY	271.82
118-620-021	6034 GOLDEN EAGLE WAY	271.82
118-620-022	6032 GOLDEN EAGLE WAY	271.82
118-620-023	6030 GOLDEN EAGLE WAY	271.82
118-620-024	6028 GOLDEN EAGLE WAY	271.82
118-620-025	6026 GOLDEN EAGLE WAY	271.82
118-620-026	6024 GOLDEN EAGLE WAY	271.82
118-620-027	6022 GOLDEN EAGLE WAY	271.82
118-620-028	6018 GOLDEN EAGLE WAY	271.82
118-620-029	7001 MOLLUK WAY	271.82



City of Clayton
Community Facilities District 1990-1R
Clayton Middle School
Fiscal Year 2017/18 Special Tax Roll

APN	Situs Address	Levy
118-620-030	7003 MOLLUK WAY	271.82
118-620-031	7005 MOLLUK WAY	271.82
118-620-032	7007 MOLLUK WAY	271.82
118-620-033	7009 MOLLUK WAY	271.82
118-620-034	7011 MOLLUK WAY	271.82
118-620-035	7015 MOLLUK WAY	271.82
118-620-036	7019 MOLLUK WAY	271.82
118-620-037	7021 MOLLUK WAY	271.82
118-620-038	7023 MOLLUK WAY	271.82
118-620-039	7025 MOLLUK WAY	271.82
118-620-040	7027 MOLLUK WAY	271.82
118-620-041	7028 MOLLUK WAY	271.82
118-620-042	7026 MOLLUK WAY	271.82
118-620-043	7024 MOLLUK WAY	271.82
118-620-044	7022 MOLLUK WAY	271.82
118-620-045	7020 MOLLUK WAY	271.82
118-620-046	7018 MOLLUK WAY	271.82
118-620-047	7016 MOLLUK WAY	271.82
118-620-048	7014 MOLLUK WAY	271.82
118-620-049	7012 MOLLUK WAY	271.82
118-620-050	7010 MOLLUK WAY	271.82
118-620-051	7008 MOLLUK WAY	271.82
118-620-052	7006 MOLLUK WAY	271.82
118-620-053	7004 MOLLUK WAY	271.82
118-620-054	7002 MOLLUK WAY	271.82
118-620-055	7000 MOLLUK WAY	271.82
118-620-056	5151 KELLER RIDGE DR	271.82
118-620-057	5153 KELLER RIDGE DR	271.82
118-620-058	5155 KELLER RIDGE DR	271.82
118-620-059	5157 KELLER RIDGE DR	271.82
118-620-060	5159 KELLER RIDGE DR	271.82
118-620-061	5161 KELLER RIDGE DR	271.82
118-620-062	5163 KELLER RIDGE DR	271.82
118-630-001	6015 GOLDEN EAGLE WAY	271.82
118-630-002	6017 GOLDEN EAGLE WAY	271.82
118-630-003	6019 GOLDEN EAGLE WAY	271.82
118-630-004	6021 GOLDEN EAGLE WAY	271.82
118-630-005	6023 GOLDEN EAGLE WAY	271.82
118-630-006	6025 GOLDEN EAGLE WAY	271.82
118-630-007	6027 GOLDEN EAGLE WAY	271.82



City of Clayton
Community Facilities District 1990-1R
Clayton Middle School
Fiscal Year 2017/18 Special Tax Roll

APN	Situs Address	Levy
118-630-008	6031 GOLDEN EAGLE WAY	271.82
118-630-009	3072 WINDMILL CANYON DR	271.82
118-630-010	3070 WINDMILL CANYON DR	271.82
118-630-011	3068 WINDMILL CANYON DR	271.82
118-630-012	3066 WINDMILL CANYON DR	271.82
118-630-013	3064 WINDMILL CANYON DR	271.82
118-630-014	3062 WINDMILL CANYON DR	271.82
118-630-015	3060 WINDMILL CANYON DR	271.82
118-630-016	3058 WINDMILL CANYON DR	271.82
118-630-017	3056 WINDMILL CANYON DR	271.82
118-630-018	3054 WINDMILL CANYON DR	271.82
118-630-019	3055 WINDMILL CANYON DR	271.82
118-630-020	3057 WINDMILL CANYON DR	271.82
118-630-021	3059 WINDMILL CANYON DR	271.82
118-630-022	3061 WINDMILL CANYON DR	271.82
118-630-023	3063 WINDMILL CANYON DR	271.82
118-630-024	3065 WINDMILL CANYON DR	271.82
118-630-025	3067 WINDMILL CANYON DR	271.82
118-630-026	3069 WINDMILL CANYON DR	271.82
118-630-027	3071 WINDMILL CANYON DR	271.82
118-630-028	3073 WINDMILL CANYON DR	271.82
118-630-029	3075 WINDMILL CANYON DR	271.82
118-630-030	3077 WINDMILL CANYON DR	271.82
118-630-031	3079 WINDMILL CANYON DR	271.82
118-630-032	3081 WINDMILL CANYON DR	271.82
118-630-033	3083 WINDMILL CANYON DR	271.82
118-630-034	3085 WINDMILL CANYON DR	271.82
118-630-035	3087 WINDMILL CANYON DR	271.82
118-630-036	3090 WINDMILL CANYON DR	271.82
118-630-037	3088 WINDMILL CANYON DR	271.82
118-630-038	3084 WINDMILL CANYON DR	271.82
118-630-039	3080 WINDMILL CANYON DR	271.82
118-630-040	3078 WINDMILL CANYON DR	271.82
118-640-001	5171 KELLER RIDGE DR	406.16
118-640-002	5173 KELLER RIDGE DR	406.16
118-640-003	5175 KELLER RIDGE DR	406.16
118-640-004	5177 KELLER RIDGE DR	406.16
118-640-005	5179 KELLER RIDGE DR	406.16
118-640-006	5181 KELLER RIDGE DR	406.16
118-640-007	5183 KELLER RIDGE DR	406.16



City of Clayton
Community Facilities District 1990-1R
Clayton Middle School
Fiscal Year 2017/18 Special Tax Roll

APN	Situs Address	Levy
118-640-008	5185 KELLER RIDGE DR	406.16
118-640-009	5187 KELLER RIDGE DR	406.16
118-640-010	5189 KELLER RIDGE DR	406.16
118-640-011	705 ACORN DR	406.16
118-640-012	707 ACORN DR	406.16
118-640-014	711 ACORN DR	406.16
118-640-015	713 ACORN DR	406.16
118-640-016	715 ACORN DR	406.16
118-640-017	717 ACORN DR	406.16
118-640-018	719 ACORN DR	406.16
118-640-019	721 ACORN DR	406.16
118-640-020	716 ACORN DR	406.16
118-640-022	901 DEER PL	406.16
118-640-024	905 DEER PL	406.16
118-640-025	904 DEER PL	406.16
118-640-026	902 DEER PL	406.16
118-640-027	5188 KELLER RIDGE DR	406.16
118-640-028	5186 KELLER RIDGE DR	406.16
118-640-029	5184 KELLER RIDGE DR	406.16
118-640-030	8001 KELOK WAY	406.16
118-640-031	8003 KELOK WAY	406.16
118-640-032	8005 KELOK WAY	406.16
118-640-033	8007 KELOK WAY	406.16
118-640-034	81 BEAR PL	406.16
118-640-035	83 BEAR PL	406.16
118-640-036	80 BEAR PL	406.16
118-640-037	8011 KELOK WAY	406.16
118-640-038	8010 KELOK WAY	406.16
118-640-039	8008 KELOK WAY	406.16
118-640-040	8006 KELOK WAY	406.16
118-640-041	8004 KELOK WAY	406.16
118-640-042	8002 KELOK WAY	406.16
118-640-043	8000 KELOK WAY	406.16
118-640-044	5174 KELLER RIDGE DR	406.16
118-640-046	903 DEER PL	406.16
118-640-047	714 ACORN DR	406.16
118-640-048	709 ACORN DR	406.16
118-650-001	5191 KELLER RIDGE DR	406.16
118-650-002	9001 ELK DR	406.16
118-650-003	9003 ELK DR	406.16



City of Clayton
Community Facilities District 1990-1R
Clayton Middle School
Fiscal Year 2017/18 Special Tax Roll

APN	Situs Address	Levy
118-650-004	9005 ELK DR	406.16
118-650-005	701 ACORN DR	406.16
118-650-006	703 ACORN DR	406.16
118-650-007	908 DEER PL	406.16
118-650-008	906 DEER PL	406.16
118-650-009	801 GREY FOX PL	406.16
118-650-010	803 GREY FOX PL	406.16
118-650-011	805 GRAY FOX PL	406.16
118-650-012	807 GREY FOX PL	406.16
118-650-013	809 GREY FOX PL	406.16
118-650-014	806 GREY FOX PL	406.16
118-650-015	804 GREY FOX PL	406.16
118-650-016	800 GRAY FOX PL	406.16
118-650-017	9007 ELK DR	406.16
118-650-018	9009 ELK DR	406.16
118-650-019	9011 ELK DR	406.16
118-650-020	9013 ELK DR	406.16
118-650-021	9008 ELK DR	406.16
118-650-022	9006 ELK DR	406.16
118-650-023	9004 ELK DR	406.16
118-650-024	9002 ELK DR	406.16
118-650-025	5193 KELLER RIDGE DR	406.16
118-650-026	5194 KELLER RIDGE DR	406.16
118-650-027	5192 KELLER RIDGE DR	406.16
118-650-028	5190 KELLER RIDGE DR	406.16
118-650-029	85 BEAR PL	406.16
118-650-030	84 BEAR PL	406.16
118-650-031	82 BEAR PL	406.16
118-660-001	4405 COYOTE CIR	189.70
118-660-002	4407 COYOTE CIR	189.70
118-660-003	4403 COYOTE CIR	189.70
118-660-004	4401 COYOTE CIR	189.70
118-660-006	4307 COYOTE CIR	189.70
118-660-007	4305 COYOTE CIR	189.70
118-660-008	4301 COYOTE CIR	189.70
118-660-009	4303 COYOTE CIR	189.70
118-660-013	4005 COYOTE CIR	189.70
118-660-014	4007 COYOTE CIR	189.70
118-660-015	4003 COYOTE CIR	189.70
118-660-016	4001 COYOTE CIR	189.70



City of Clayton
Community Facilities District 1990-1R
Clayton Middle School
Fiscal Year 2017/18 Special Tax Roll

APN	Situs Address	Levy
118-660-019	3407 COYOTE CIR	189.70
118-660-020	3405 COYOTE CIR	189.70
118-660-021	3401 COYOTE CIR	189.70
118-660-022	3403 COYOTE CIR	189.70
118-660-024	3307 COYOTE CIR	189.70
118-660-025	3305 COYOTE CIR	189.70
118-660-026	3301 COYOTE CIR	189.70
118-660-027	3303 COYOTE CIR	189.70
118-660-029	3205 COYOTE CIR	189.70
118-660-030	3207 COYOTE CIR	189.70
118-660-031	3203 COYOTE CIR	189.70
118-660-032	3201 COYOTE CIR	189.70
118-660-036	2907 COYOTE CIR	189.70
118-660-037	2905 COYOTE CIR	189.70
118-660-038	2901 COYOTE CIR	189.70
118-660-039	2903 COYOTE CIR	189.70
118-660-047	4207 COYOTE CIR	189.70
118-660-048	4205 COYOTE CIR	189.70
118-660-049	4201 COYOTE CIR	189.70
118-660-050	4203 COYOTE CIR	189.70
118-660-052	4107 COYOTE CIR	189.70
118-660-053	4105 COYOTE CIR	189.70
118-660-054	4101 COYOTE CIR	189.70
118-660-055	4103 COYOTE CIR	189.70
118-660-057	3105 COYOTE CIR	189.70
118-660-058	3107 COYOTE CIR	189.70
118-660-059	3103 COYOTE CIR	189.70
118-660-060	3101 COYOTE CIR	189.70
118-660-062	3005 COYOTE CIR	189.70
118-660-063	3007 COYOTE CIR	189.70
118-660-064	3003 COYOTE CIR	189.70
118-660-065	3001 COYOTE CIR	189.70
118-660-067	3507 COYOTE CIR	189.70
118-660-068	3505 COYOTE CIR	189.70
118-660-069	3501 COYOTE CIR	189.70
118-660-070	3503 COYOTE CIR	189.70
118-660-071	3104 COYOTE CIR	189.70
118-660-072	3102 COYOTE CIR	189.70
118-660-073	3106 COYOTE CIR	189.70
118-660-074	3108 COYOTE CIR	189.70



City of Clayton
Community Facilities District 1990-1R
Clayton Middle School
Fiscal Year 2017/18 Special Tax Roll

APN	Situs Address	Levy
118-660-075	3902 COYOTE CIR	189.70
118-660-076	3904 COYOTE CIR	189.70
118-660-077	3906 COYOTE CIR	189.70
118-660-078	3908 COYOTE CIR	189.70
118-660-079	4104 COYOTE CIR	189.70
118-660-080	4102 COYOTE CIR	189.70
118-660-081	4106 COYOTE CIR	189.70
118-660-082	4108 COYOTE CIR	189.70
118-670-001	8012 KELOK WAY	406.16
118-670-002	8014 KELOK WAY	406.16
118-670-003	8016 KELOK WAY	406.16
118-670-004	8018 KELOK WAY	406.16
118-670-005	8020 KELOK WAY	406.16
118-670-006	8022 KELOK WAY	406.16
118-670-007	8024 KELOK WAY	406.16
118-670-008	8026 KELOK WAY	406.16
118-670-009	8028 KELOK WAY	406.16
118-670-010	8030 KELOK WAY	406.16
118-670-011	8032 KELOK WAY	406.16
118-670-012	8034 KELOK WAY	406.16
118-670-013	8036 KELOK WAY	406.16
118-670-014	8038 KELOK WAY	406.16
118-670-015	8040 KELOK WAY	406.16
118-670-016	8042 KELOK WAY	406.16
118-670-017	8053 KELOK WAY	406.16
118-670-018	8051 KELOK WAY	406.16
118-670-019	8049 KELOK WAY	406.16
118-670-020	8047 KELOK WAY	406.16
118-670-021	8045 KELOK WAY	406.16
118-670-022	8043 KELOK WAY	406.16
118-670-023	8041 KELOK WAY	406.16
118-670-024	8039 KELOK WAY	406.16
118-670-025	8037 KELOK WAY	406.16
118-670-026	5229 KELLER RIDGE DR	406.16
118-670-027	5227 KELLER RIDGE DR	406.16
118-670-028	5225 KELLER RIDGE DR	406.16
118-670-029	5223 KELLER RIDGE DR	406.16
118-670-030	5222 KELLER RIDGE DR	406.16
118-670-031	5224 KELLER RIDGE DR	406.16
118-670-032	5226 KELLER RIDGE DR	406.16



City of Clayton
Community Facilities District 1990-1R
Clayton Middle School
Fiscal Year 2017/18 Special Tax Roll

APN	Situs Address	Levy
118-670-033	5230 KELLER RIDGE DR	406.16
118-670-034	8027 KELOK WAY	406.16
118-670-035	8025 KELOK WAY	406.16
118-670-036	8023 KELOK WAY	406.16
118-670-037	8021 KELOK WAY	406.16
118-670-038	8019 KELOK WAY	406.16
118-670-039	8017 KELOK WAY	406.16
118-670-040	90 KELOK CT	406.16
118-670-041	92 KELOK CT	406.16
118-670-042	94 KELOK WAY	406.16
118-670-043	8015 KELOK WAY	406.16
118-670-044	8013 KELOK WAY	406.16
118-680-001	5221 KELLER RIDGE DR	406.16
118-680-002	5219 KELLER RIDGE DR	406.16
118-680-003	5217 KELLER RIDGE DR	406.16
118-680-004	5215 KELLER RIDGE DR	406.16
118-680-005	5213 KELLER RIDGE DR	406.16
118-680-006	5211 KELLER RIDGE DR	406.16
118-680-007	5209 KELLER RIDGE DR	406.16
118-680-008	5207 KELLER RIDGE DR	406.16
118-680-009	5205 KELLER RIDGE DR	406.16
118-680-010	5203 KELLER RIDGE DR	406.16
118-680-011	5201 KELLER RIDGE DR	406.16
118-680-012	5199 KELLER RIDGE DR	406.16
118-680-013	5197 KELLER RIDGE DR	406.16
118-680-014	5195 KELLER RIDGE DR	406.16
118-680-015	5198 KELLER RIDGE DR	406.16
118-680-016	5200 KELLER RIDGE DR	406.16
118-680-017	5202 KELLER RIDGE DR	406.16
118-680-018	5204 KELLER RIDGE DR	406.16
118-680-019	5206 KELLER RIDGE DR	406.16
118-680-020	5208 KELLER RIDGE DR	406.16
118-680-021	5210 KELLER RIDGE DR	406.16
118-680-022	5212 KELLER RIDGE DR	406.16
118-680-023	5214 KELLER RIDGE DR	406.16
118-680-024	5216 KELLER RIDGE DR	406.16
118-680-025	5218 KELLER RIDGE DR	406.16
118-680-026	5220 KELLER RIDGE DR	406.16
Totals:	1358 Parcels	\$397,795.70

